

**Group 300** Dial Gauges  
  
 Page ..... **250 - 251**

**Group 302** Axis Gauging  
  
 Page ..... **252**

**Group 303** Hardness Testers  
  
 Page ..... **253**

**Group 306** Granite Blocks & Plates  
  
 Page ..... **254**

**Group 312** Environment Meters  
  
 Page ..... **255**

**Group 314** Counters & Stopwatches  
  
 Page ..... **256**

**Group 316** Eye Loupes & Magnifiers  
  
 Page ..... **257 - 258**

**Group 330** Protractors & Combination Sets  
  
 Page ..... **260**

**Group 330** Height & Thickness Gauges  
  
 Page ..... **260**

**Group 330** Calipers  
  
 Page ..... **261**

**Group 331** Digital Calipers  
  
 Page ..... **262**

**Group 331** Digital Depth Gauges  
  
 Page ..... **264**

**Group 331** Digital Indicators  
  
 Page ..... **265**

**Group 331** Digital Micrometers  
  
 Page ..... **265**

**Group 333** Magnetic Bases & Fitments  
  
 Page ..... **266 - 269**

**Group 335** Bore Gauges  
  
 Page ..... **271**

**Group 335** Micrometers  
  
 Page ..... **272 - 275**

**Group 336** Refractometers  
  
 Page ..... **276**

**Group 338** Gauge Blocks  
  
 Page ..... **277**

**Group 340** Engineer's Levels & Squares  
  
 Page ..... **278**

**Group 370** Steel Blocks & Plates  
  
 Page ..... **280 - 281**

**Group 372** Steel Parallels  
  
 Page ..... **279**

**Group 540** Liquid Measures  
  
 Page ..... **281**

**Group 844** Scales  
  
 Page ..... **281**

# Precision & Equipment

## Product Groups 300 - 844

## Contents

Description	Group	Page
Anemometer	312	255
Axis Gauging	302	252
Bevel Protractors	330	260
Binoculars	318	259
Bore Gauges	335	271
Calipers - Dial	330	261
- Vernier	330	262
Combination Sets	330	260
Counters	314	256
Dial Gauges	300	250 - 251
Digital - Calipers	331	263 - 264
- Depth Gauges	331	264
- Indicators	331	265
- Micrometers	331	265
- Protractors	331	278
Engineer's Levels & Squares	341	278
Environment Meters	312	255
Eye Loupes & Magnifiers	316	257 - 258
Granite Products	306	254
Hardness Testers	303	253
Height Gauges	330	260

Description	Group	Page
Humidity & Temperature Tester	312	255
Liquid Measures	540	281
Magnetic Bases & Comparator Stands	333	266 - 269
Magnifiers	316	257 - 258
Micrometer Heads	335	274
Micrometers - Bore	335	270
- Depth	335	271
- Digital	331	265
- External	335	272 - 275
Precision Tool Sets	335	275 - 276
Refractometers	336	276
Scales	844	281
Steel - Angle Plates	370	281
- Gauge Blocks	338	277
- Parallels	372	279
- Vee Blocks	370	280
Stopwatches	314	256
Tally Counters	314	256
Thermometers	312	255
Thickness Gauges - Dial	330	261

# Dial Gauges

Precision & Equipment

**OXFORD**  
PRECISION

## Easy Read Dial Gauges Plunger Type



**58mm (2 1/4") Diameter Dial**  
Matt finish chromed housing and black oxidised limit hands. Fitted with 1/4" inside diameter stem.  
Manufactured to **BS 907**.



**58mm  
Diameter**

### Spares to suit Oxford Plunger Type Gauges

Description	Order Code KEN-301
Anvil - mm	<b>-9400K</b>
Anvil - inch	<b>-9410K</b>

Resolution	Travel	Reading	Weight each	Order Code OXD-300
0.001"	0.5"	0-50-0	440g	<b>-8100K</b>
0.01mm	5mm	0-50-0	350g	<b>-7850K</b>
0.01mm	10mm	0-100	440g	<b>-8500K</b>
0.01mm	25mm	0-100	440g	<b>-8520K</b>

## Easy Read Dial Gauge Plunger Type

**58mm (2 1/4") Diameter Dial**  
**6 Jewel**  
Matt finish chromed housing and black oxidised limit hands. Shockproof mechanism. Fitted with 1/4" inside diameter stem.  
Manufactured to **BS 907**.



**JEWELLED**

**58mm  
Diameter**

### Spares to suit Oxford Plunger Type Gauges

Description	Order Code KEN-301
Anvil - mm	<b>-9400K</b>

Resolution	Travel	Reading	Weight each	Order Code OXD-300
0.01mm	10mm	0-100	440g	<b>-5500K</b>
0.01mm	25mm	0-100	440g	<b>-5520K</b>

**KENNEDY**  
QUALITY INDUSTRIAL TOOLING

## Easy Read Dial Gauges Plunger Type



**58mm (2 1/4") Diameter Dial**  
Easy Read Dial Gauges and DTI's are designed for countless applications and available in two basic styles. With shockproof mechanisms and clear, 'Easy Read' dial for zero setting. All models are operational in both directions. Supplied in fitted cases with accessories storage space. Matt finish chromed housing and black oxidised limit hands. Fitted with 1/4" inside diameter centre back lug and 5/16" diameter stem.  
Manufactured to **BS 907**.



**58mm  
Diameter**

### Spares to suit Kennedy Plunger Type Gauges

Description	Order Code KEN-301
Anvil - mm	<b>-9400K</b>
Anvil - inch	<b>-9410K</b>

Resolution	Travel	Reading	Weight each	Order Code KEN-300
0.001"	0.5"	0-50-0	440g	<b>-7100K</b>
0.001"	0.5"	0-100	440g	<b>-7110K</b>
0.001"	1.0"	0-100	440g	<b>-7160K</b>
0.0005"	1.0"	0-50	440g	<b>-7170K</b>
0.01mm	10mm	0-100	440g	<b>-7500K</b>
0.01mm	25mm	0-100	440g	<b>-7520K</b>

## Smile Dial Gauges Plunger Type

**58mm (2 1/4") Diameter Dial**  
Matt finish chromed housing and black oxidised limit hands. Jewelled. Fitted with 1/4" inside diameter centre back lug and 5/16" diameter stem.  
Manufactured to **BS 907**.

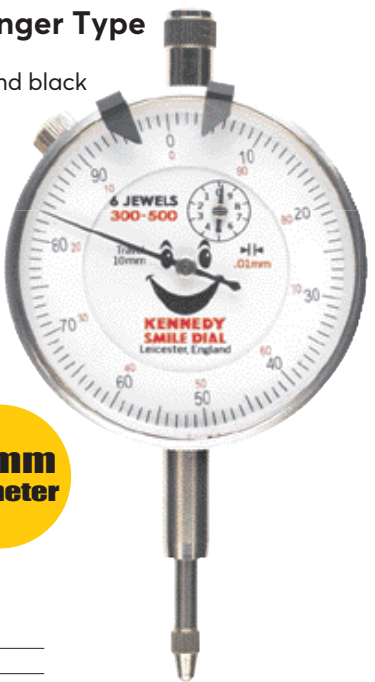

**JEWELLED**

**58mm  
Diameter**

### Spares to suit Kennedy Plunger Type Gauges

Description	Order Code KEN-301
Anvil - mm	<b>-9400K</b>

Resolution	Travel	Reading	Weight each	Order Code KEN-300
0.01mm	10mm	0-100	440g	<b>-5000K</b>

**KENNEDY**  
QUALITY INDUSTRIAL TOOLING

## Dovetail Mounting Accessories

**Spigot**  
1/4" standard type.



Stem Diameter	Weight each	Order Code KEN-398
4mm	20g	<b>-0330K</b>
6mm	20g	<b>-0340K</b>
8mm	20g	<b>-0350K</b>

## Dial Gauge Accessories

**Replacement Anvils**  
For all Kennedy plun-  
type dial gauges. Ste



Type	Weight each	Order Code KEN-301
Metric	.082g	<b>-9400K</b>
Inch	.082g	<b>-9410K</b>

## Universal Spigot

For lever type (not easy read).



Type	Weight each	Order Code KEN-301
1/4" ID	20g	<b>-9840K</b>

## Replacement Stylus

Carbide steel. Replacement stylus for all Kennedy lever type dial test indicators (except dual reading stylus for KEN-300-4000K).

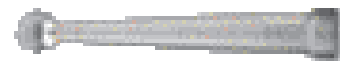

Suitable For	Order Code KEN-301
Old Style Metric Types Only	<b>-9440K</b>
Old Style Imperial Types Only	<b>-9630K</b>

**OXFORD PRECISION** Easy Read Dial Test Indicators

**32mm Diameter Dial Lever Type**  
Supplied with dovetail fitting and 6 and 8mm spigot. Matt finish chromed housing.



**Spares to suit Oxford Dial Test Indicators**

Description	Order Code
Replacement Stylus	<b>-9630K</b>
Universal Holder	<b>-9840K</b>
	Order Code
	<b>KEN-398</b>
1/4" Spigot - 6mm Stem	<b>-0340K</b>
1/4" Spigot - 8mm Stem	<b>-0350K</b>

Resolution	Travel	Reading	Weight each	Order Code
0.01mm	0.8mm	0-40-0	170g	<b>-9020K</b>

**1 1/4" Dial Diameter**



**Spares to suit Oxford Dial Test Indicators**

Description	Order Code
Replacement Stylus	<b>-9630K</b>
Universal Holder	<b>-9840K</b>
	Order Code
	<b>KEN-398</b>
1/4" Spigot - 6mm Stem	<b>-0340K</b>
1/4" Spigot - 8mm Stem	<b>-0350K</b>

Resolution	Travel	Reading	Weight each	Order Code
0.0005"	0.03"	0-15-0	170g	<b>-9010K</b>



**KENNEDY QUALITY INDUSTRIAL TOOLING** Easy Read Anti-Magnetic Dial Test Indicators

**32mm (1 1/4") Diameter Dial Lever Type**  
Supplied with dovetail fitting and 6 and 8mm spigot. Matt finish chromed housing. Jewelled.

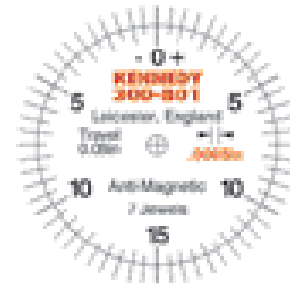

**JEWELLED**

**Spares to suit Kennedy Dial Test Indicators**

Description	Order Code
Replacement Stylus	<b>-9630K</b>
	Order Code
	<b>KEN-398</b>
1/4" Spigot - 6mm Stem	<b>-0340K</b>
1/4" Spigot - 8mm Stem	<b>-0350K</b>

Resolution	Travel	Reading	Weight each	Order Code
0.0005"	0.03"	0-15-0	170g	<b>-8010K</b>
0.01mm	0.8mm	0-40-0	170g	<b>-8020K</b>

**OXFORD PRECISION** Vertical Lever Dial Gauge

Anti-magnetic lever dial gauge with jewelled movement for a smooth and precise operation. Measuring direction automatically adapts on contact. Supplied with basic set of mounting accessories and case.

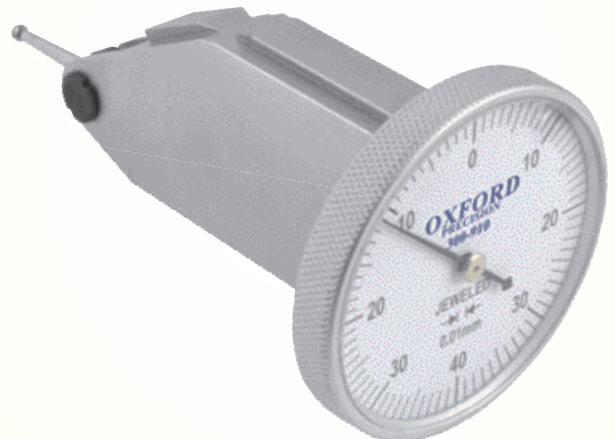

Range	Accuracy	Graduation	Measuring Force	Reading	Order Code
0.8mm	±0.01mm	0.01mm	0.1N-0.5N	0-40-0	<b>-9100K</b>

## KENNEDY 3D Axis Gauging

QUALITY INDUSTRIAL TOOLING

The New Generation of NC axis gauging equipment, for quick, accurate setting of all three axes (X, Y, Z) by analogue differential indicator. Suitable for all machine tools with CNC, NC or DRO and also for EDM/spark erosion tools - the stylus is electrically insulated from the spindle. Universal - one tool measures length, height, diameter and centre. The synchronous single needle allows greater needle displacement before reaching "12 o'clock". A positive reading is given regardless of direction of axis movement. No calculations and no 'trial and error' involved. Increases production and efficiency, reduces job time and operator requirement. The stylus is designed to break on a 'nominal fracture' before the workpiece or tester can be damaged. Three plug in styli types can be changed in seconds without the use of special tools. Pre-adjusted to a concentricity of 0.01mm maximum.

**Indicator diameter:** 50mm.  
**Clamping shank diameter:** 16mm.

Scale for radial and axial approach

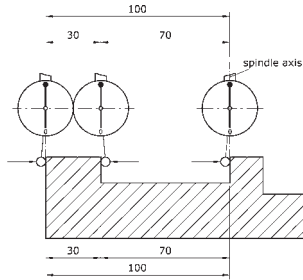

a. Measuring length

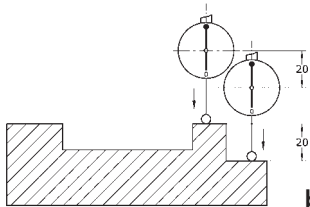

b. Measuring height

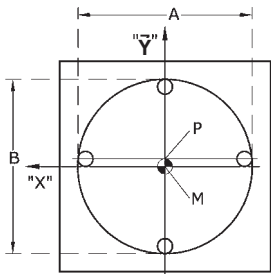

c. Establishing true centre and diameter of bores.

Insert stylus roughly in centre of bore, measure distance A and divide by 2 (P). Measure distance B in Y direction, across point P and divide by 2.

Result: true centre point (M). Repeat measuring of distance A.

### 3D Axis Gauge

Indicator Dia.	Effective Length	Shank Dia.	Weight each	Order Code
50mm	125mm	16mm	89g	KEN-302 -2010K

### Stylii

Conical precision plug-in mechanism. Insulated, no electrical conductivity. Designed-in nominal fracture point.

Type	Length mm	Anvil Dia.	Weight each	Order Code
Short	33	4.0	3g	KEN-302 -2130K
Long	72	6.0	10g	-2170K



Stylus ball

**OXFORD PRECISION** Hardness Testers

**Rockwell Hardness Tester**

For testing the hardness of hard alloys, quenched and unquenched steels, using steel ball or diamond penetrators to measure Rockwell A, B & C units of measurement. Supplied with test block, flat large, small and V notch anvils, steel ball bearing indenter and diamond indenter. Manufactured in accordance with **ISO 6508-2:1999 & ASTM E18**.

**Measuring ranges:**

20-88HRA (Test force: 588.4N/60kgf),  
20-100HRB (Test force: 980.7N/100kgf),  
20-70HRC (Test force: 1471N/150kgf).

**Max height of test piece:**

80mm with screw protective jacket, 170mm without.

**Depth of throat:** 135mm.

**Dimensions:** 466 x 238 x 630mm.

Precision & Equipment



Product Number	Weight each	Order Code
150R	65kg	<b>OXD-303</b> <b>-1000K</b>

**Anvils, Indentors & Test Blocks**

To suit Oxford hardness tester.

**Large Flat Anvil**



**Small Flat Anvil**



**Steel Ball Bearing Indentor**

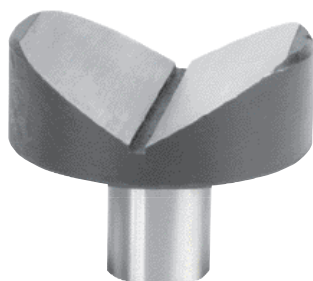

**V-Notch Anvil**



**Diamond Indentor**

**Test Block**



Description	Size	Order Code
Large Flat Anvil	150mm	<b>-9100K</b>
Small Flat Anvil	58mm	<b>-9110K</b>
V-Notch Anvil	-	<b>-9120K</b>
Diamond Indentor	Æ1.588mm	<b>-9150K</b>
Steel Ball Bearing Indentor	Æ.588mm	<b>-9160K</b>
Rockwell Std. Test Blocks 60 x 40 x 10mm	88 HRA	<b>-9200K</b>
	85 HRB	<b>-9210K</b>
	60 HRC	<b>-9220K</b>
	35 HRC	<b>-9230K</b>
	20 HRC	<b>-9240K</b>



## Oxford Precision Granite Products

Precision granite products are manufactured to the highest quality standards to provide an accurate surface from which final measurements can be taken. More dimensionally stable than steel or cast iron, with a low thermal expansion co-efficient. Does not burr, is corrosion free and easy to maintain.

### Granite Surface Plates

Accurate bases which are used for mounting sensitive measuring, mechanical and electronic equipment. Made to **BS817**.

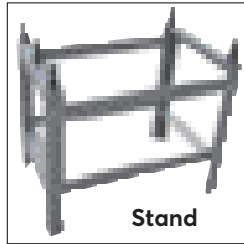
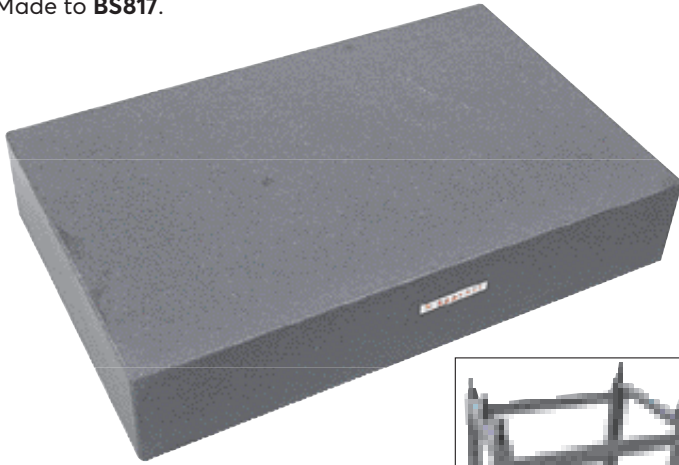

### Grade 1 - Inspection Grade

L x W x H	Weight each	Order Code <b>OXD-306</b>
400 x 250 x 70mm	27kg	<b>-4020K</b>
630 x 400 x 100mm	90kg	<b>-4040K</b>
800 x 500 x 100mm	140kg	<b>-4060K</b>

### Stand - To suit Granite Surface Plate (OXD-306-4060K and -3860K) Only

L x W x H	Weight each	Order Code <b>OXD-306</b>
480 x 300 x 650mm	20kg	<b>-4100K</b>

### Granite Squares

90°. For measuring and inspecting squareness, parallelism and alignment. Made to **BS939 : 1977 Grade A** for flatness, straightness and squareness of working faces.

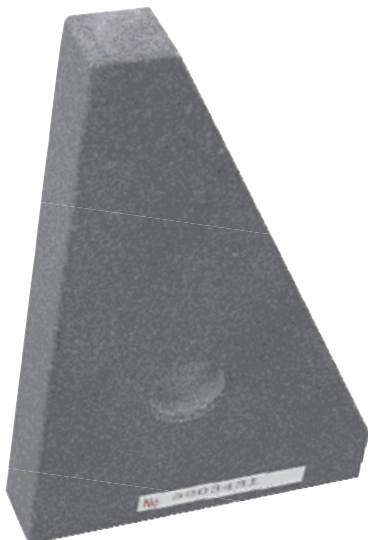

W x H	Weight each	Order Code <b>OXD-306</b>
250 x 160mm	2.26kg	<b>-5060K</b>

### Granite Straight Edges

Used for checking surfaces for straightness, drawing and scribing straight lines. Made to **BS5204 : Grade A**.

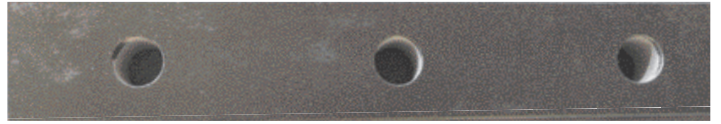

L x W x H	Weight each	Order Code <b>OXD-306</b>
630 x 100 x 50mm	7kg	<b>-6020K</b>
1000 x 160 x 50mm	10kg	<b>-6040K</b>

### Granite Parallels

Used for setting up work on machine tables and surface plates. Made to **BS906 : Part 1 : Grade B** for flatness and parallelism of working faces. Supplied in pairs.

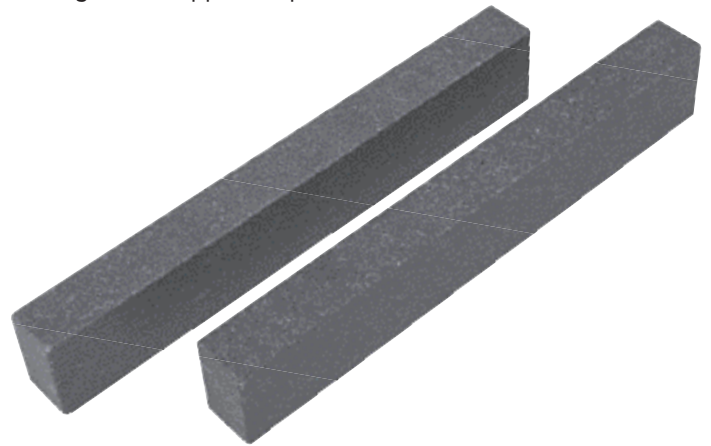

L x W x H	Weight each	Order Code <b>OXD-306</b>
160 x 25 x 16mm	0.55kg	<b>-3020K</b>
250 x 40 x 25mm	1.83kg	<b>-3040K</b>
400 x 63 x 40mm	6.97kg	<b>-3060K</b>

### Granite Vee Blocks

90°. Used for handling and inspecting round work. Also used for layout work. Made to **BS3731 : Grade 2**. Supplied in pairs.

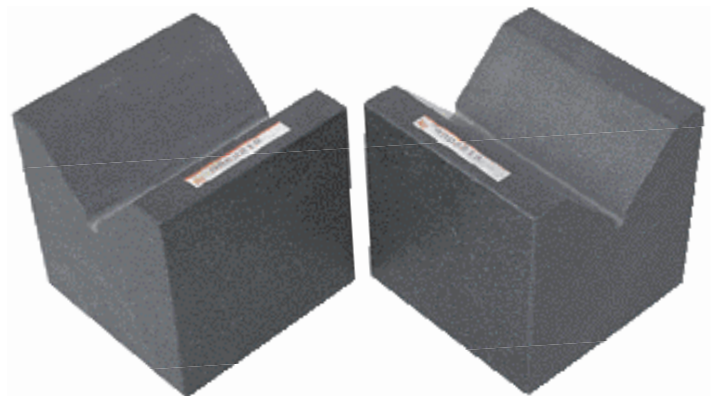

L x W x H	Weight each	Order Code <b>OXD-306</b>
62 x 62 x 62mm	2.0kg	<b>-7020K</b>

## EDISON Mini Laser Thermometer

Pocket sized infrared thermometer employing single dot infrared laser technology to instantly display surface temperatures. °C/°F selectable with a measurement range of between -20°C to 270°C (-4° to 518°F). Features ambient temperature (TAMB) measurement, back light, hold function and low battery indication. Supplied with wrist lanyard and 2x AAA batteries.



## OXFORD PRECISION 2-in-1 Food Safety Infrared Thermometer

Infrared and contact thermometer for surface scans with a probe thermometer and alarm monitoring for internal temperature readings. The Thermometer will measure the surface and inside temperature of an object. It is ideal to be used in the professional food temperature measurement. It is also a handy tool in restaurant and kitchen.

### Features:

- Built-in fold-out probe for measuring internal food temperature.
- MIN/MAX temperature display for quick reference.
- Small modern housing design.



**4:1** Distance to Spot  
**-40°C** to **+280°C**

**6:1** Distance to Spot

**-20°C** to **+270°C**



Model Number **EDI-312**  
 Order Code **-3960K**

THB

Order Code **OXD-312**  
**-3560K**

THB

## OXFORD PRECISION Mini Humidity & Temperature Tester

Measures temperature and humidity with low power consumption and high precision. These meters can be used in factories, laboratories, research institutes, food, health, environmental protection, and other fields.

### Features:

- Display temperature, humidity and dew point temperature selection together
- / Selectable
- Customised measurement compensation
- Record interval, system time and sleep time settings
- MAX/MIN modes
- 100 sets data storage, manual/auto storage modes
- Data hold and LCD backlight



**new**

## OXFORD PRECISION Mini Anemometer

Measures temperature, wind speed, and wind count. Can be used in energy saving, HVAC, fishing and other industries that use exhaust or ventilation systems.

### Features:

- Data hold, LCD backlight
- / Selectable
- Auto power off (cancelable)
- 2044 sets data storage
- Auto record function with 0.5~255s interval
- Wear-proof fan shaft for improved accuracy and reliability
- Wind speed modes: MAX, MIN, Real-time
- Wind count modes: MAX, 2/3 MAX, MIN, AVG, real-time
- 7 Selectable units: m/s, km/h, ft/min, MPH, KNOTS, CFM, CMM
- Range: -10°C to 50°C; 14°F to 122°F; 0 to 30m/s



**new**

Range **°C**  
 -10 to 60

Range **°F**  
 14 to 140

Order Code **OXD-312**  
**-5666K**

Order Code **OXD-312**  
**-5643D**



## **RUTLAND** III SPORT Multi Function Digital Stopwatch - Standard

Water and shock resistant design. Supplied with nylon neck cord.

**Specification:**  
1/100 second precision with split times. Calendar and time display 12hr or 24hr format. Daily alarm. Hourly chime. Supplied complete with 1.5V battery.



Order Code  
**RTL-314**  
**-3020K**

## Multi Function Digital Stopwatch

Large screen, three row display. Time, date and 12/24 hr display. 80 laps and split memory at 1/100 sec. Fastest, slowest and average lap display. Co. Pacer function with selec interval. 3 sec EL backlig 3V lithium battery. Water shock resistant. Back clip lanyard included.



Order Code  
**RTL-314**  
**-3120K**

## **OXFORD** PRECISION Electronic Tally Counter - Up

Electronic tally counter counts up to 9999. Four-digit LCD with large push-buttons. High-impact construction with comfortable rubber keys. Optional audible counting indicator. Battery included.



Size (W x D x H)	Order Code
30 x 15 x 60mm	<b>OXD-314</b> <b>-5820K</b>

## Chrome Tally Counters

Four digit (0-9999) metal body mechanical counters with push button actuator and reset button. Sturdy chrome plated steel construction.



**Hand Tally** comfortably fits in the palm of your hand, audible click, finger ring and recommended for applications where operator must be mobile.

**Desk Tally** features a special mounting base designed for desk, bench or clipboard mounting. Recommended for fixed applications.

Description	Weight each	Order Code
Hand Tally	60g	<b>OXD-314</b> <b>-5500K</b>
Desk Tally	70g	<b>-5520K</b>

## Mechanical Stroke Counter

Five digit mid-range mechanical stroke counter. Tough plastic case. Excellent value.

**Overall length:** 80mm.  
**Height:** 30mm.

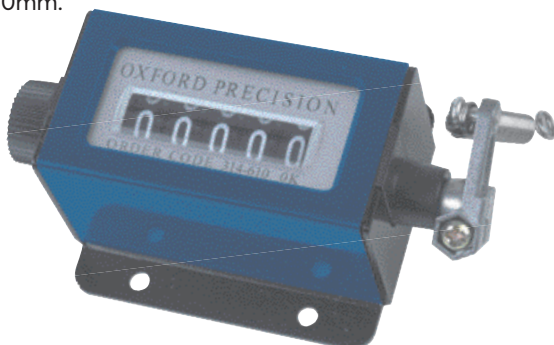

Spindle Rotation	Weight each	Order Code
Right Hand	91g	<b>OXD-314</b> <b>-6100K</b>

## Electronic Tally Counter - Up/Down

Electronic tally counter counts up to 9999. Four-digit LCD with large push-buttons. Reverse function to count down as well as up. High-impact construction with comfortable rubber keys. Optional audible counting indicator. Battery included.



Size (W x D x H)	Order Code
30 x 15 x 60mm	<b>OXD-314</b> <b>-5830K</b>

## OXFORD PRECISION LED Light Magnifier

### 30mm Diameter

10x magnification.

5mm diameter LED light. 30mm diameter integral 2x optical glass lens. Powered by 3x AAA batteries (not supplied). LED lasts around 40,000 hours under normal use. Battery life = 40/50 hours under continuous use. Compared to a conventional bulb the LED diode lives up to 1000 times longer with 90% less power consumption. Complete with plastic case with belt loop.



Order Code  
**OXD-316**  
-2010K

## Folding Pocket Magnifier

### 15mm Diameter

The original 'Linen tester'. Although deriving its name from the textile industry it is also suitable for inspecting paper, photographs, printed documents etc. 15mm diameter glass lens. 7x magnification. 1" working distance. 1/2" square field. Inch graduation. 1/8" divisions. Self-standing to free your hands. Folds flat when not in use. Black powder coated body.

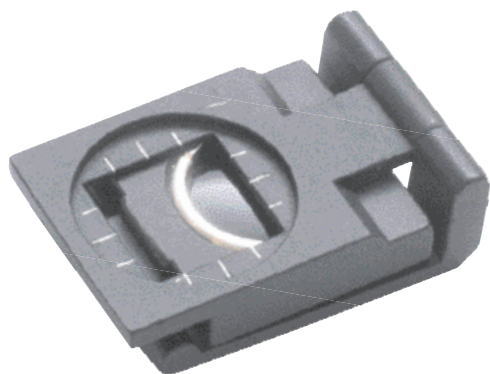

Order Code  
**OXD-316**  
-1600K

## Folding Pocket Magnifier

### 30mm Diameter

The original 'Linen tester'. Although deriving its name from the textile industry it is also suitable for inspecting paper, photographs, printed documents etc. 30mm diameter glass lens. 6x magnification. 38mm (1 1/2") working distance. 25mm (1") square field. Metric and inch graduations. 1mm and 1/8" divisions. Self-standing to free your hands. Folds flat when not in use. Black powder coated body. Comes with plastic wallet.



Order Code  
**OXD-316**  
-1620K

## Magnifying Loupes

Suitable for precision engineers', instrument makers', watch repairers', jewellers etc.

### Triplet

Provides sharp images with minimum distortion. Three separate lenses bonded together to form one compound lens. Chrome plated finish. Complete with leather case.



### Double

21mm diameter double lenses bonded together to form one compound lens. Provides a sharp magnified image with virtually no distortion.



Type	Magnification	Order Code
Triplet	10x	<b>-1500K</b>
Double	20x	<b>-1520K</b>

**OXFORD PRECISION**

## LED Desk Magnifier Lamp

### LTS600-61

- With 280mm gooseneck
- 5.4W LED
- **Lens diameter:** 90cm (3.5")
- **Magnification:** 1.75x
- **Diopter:** 3
- For inspection work, laboratories, medical and dentistry, design work, jewellers, electronics



### Spare Parts

Description	Order Code
Led Module	<b>-1612K</b>
Clamp	<b>-1624K</b>

Type	Order Code
Clamp	<b>-2620K</b>

## LED/UV Bench Magnifier

### LTS960-08-61

- With one touch dimming switch and two types of LED modules for perfect vision.
- 12.6W + 4.2W LED
- **Lens diameter:** 177cm (70")
- **Magnification:** 1.75x
- **Diopter:** 3
- Suitable for inspection work, hospitals, laboratories and beauty salons
- Can be used with a clamp



### Spare Parts

Description	Order Code
Bench Magnifier	<b>-2630K</b>

Description	Order Code
Led Module	<b>-1616K</b>
Clamp	<b>-1620K</b>

## Bench Magnifiers

89mm (3½") diameter lens. 2x magnification. Chrome plated brass frame. 180mm flexible hose length permits viewing at any angle. Suitable for viewing work requiring high precision.

### With Clamp

Black powder coated clamp provides stability and convenience. Portable and easy to clip onto a bench or table.

**Clamping capacity:** 55mm.

### With Stand

Cast horseshoe type stand provides stability and convenience.



Type	Order Code
Clamp	<b>-1100K</b>
Stand	<b>-1120K</b>

## LED Bench Magnifier

### LTS120-61-5D

- 9.4W LED
- **Lens diameter:** 125mm (5")
- **Magnification:** 2.25x
- **Diopter:** 5
- Suitable for the workplace, hobbies or for people with limited vision



### Spare Parts

Description	Order Code
Led Module	<b>-1604K</b>
Clamp	<b>-1608K</b>

Type	Order Code
Stand	<b>-2610K</b>

## LED Desk Magnifier

### LTS60002-61

- With weighted base.
- 5.4W LED
- **Lens diameter:** 90cm (3.5")
- **Magnification:** 1.75x
- **Diopter:** 3
- Ideal for painting, sewing, DIY
- Can be used with a clamp



### Spare Parts

Description	Order Code
Led Module	<b>-1612K</b>
Clamp	<b>-1624K</b>

Type	Order Code
Stand	<b>-2640K</b>

## Hand Magnifier

2x and 3x have chrome-plated brass frame and bakelite handle. 4x deluxe has a gilt-effect frame and hardwood handle.



Type	Diameter	Order Code
2x	89mm	<b>-2500K</b>
3x	50mm	<b>-2520K</b>
4x	65mm	<b>-2600K</b>

## LED Head Loupe with Removable LED Light & Interchangeable Lenses

The detachable LED light can be removed to provide an independent source of light that has two magnets for attaching to steel objects. Can be worn with spectacles and has an adjustable headband and an integral visor to cut out ambient light. It comes with four interchangeable lenses. The lenses stay firmly in position when raised or lowered, leaving both hands free to work.

### Contents:

- 1x Head Loupe with removable LED light (batteries not included).
- 1x Blanking plate for Visor when LED is removed.
- 1x **Box of four lenses:**

Magnification for Working Distance	Working Distance
1.2x	520 - 620mm
1.8x	230 - 320mm
2.5x	150 - 250mm
3.5x	80 - 120mm



Description	Order Code
LED Head Loupe	<b>-2560K</b>



**Traditional Binoculars 10 x 42**

TP1042

These binoculars have a powerful 10 x magnification using a Porro prism. **Includes** Lens caps, case, neck strap, and cleaning cloth.

**10 x 42**



**Prism type:** Porro.  
**Magnification:** 10x.  
**Objective lens:** 42mm.  
**Angle of view:** 6°.  
**Field of view at 1000m:** 105m.  
**Exit pupil:** 4.2mm.  
**Focusing method:** Manual.  
**Closest focusing distance:** 4m.  
**Dimensions:** (W x H x D) 110 x 168 x 65mm.  
**Weight:** 775g.

Diopter measurement



Fold down eye cup



Product Number  
TP1042

Order Code  
RTL-318  
-1600K

**Spotting Scope 18-36 x50**

SS3650

Complete with tripod and mounting point Includes case with shoulder strap, and cleaning cloth.



**18 - 36 x 50**

**Prism type:** Porro.  
**Magnification:** 18 - 36x.  
**Objective lens:** 50mm.  
**Angle of view:** 26 - 43°.  
**Field of view at 1000m:** 23 - 38m.  
**Exit pupil:** 1.5 - 4mm.  
**Focusing method:** Manual.  
**Dimensions:** (W x H x D) 380 x 360 x 330mm.  
**Weight:** 1190g.



Diopter measurement



Fold down eye cup



Tripod use



Product Number  
SS3650

Magnification x Lens Diameter  
18-36 x 50

Order Code  
RTL-318  
-3100K

## OXFORD PRECISION 300mm/12" Multi-function Combination Set

Fully hardened and ground datum faces. Precision rules with deeply etched graduations. Protractor has full 360° scale plate, graduated 0 - 180° - 0, includes vial. Square head offers the following fixed angles: 45° and 90°. Centre head offers a fixed 90° angle, for finding the centre of round bar stock up to 120mm diameter.

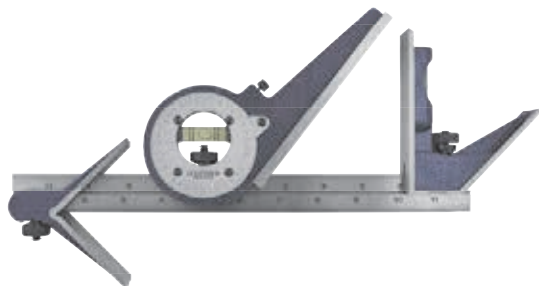

Order Code  
**OXD-330**  
**-3850K**

### Spares

Description	Order Code
	<b>OXD-330</b>
Square Head	<b>-3860K</b>
Centre Head	<b>-3870K</b>
Protractor Head	<b>-3880K</b>
12"/300mm Rule	<b>-3890K</b>
24"/600mm Rule	<b>-3900K</b>

## KENNEDY QUALITY INDUSTRIAL TOOLING 300mm/12" Multi-function Combination Set

### KCS300

Can be used as a square, mitre, depth and height gauge.

**Set Contains:** Square head with accurate machined faces, fixed angles of 45° and 90°, built-in spirit level, adjusting nut and scriber. Protractor head for measuring angles up to 180°, graduated to 1°. Centre head offers a fixed 90° angle, for finding the centre of round bar stock up to 120mm diameter. 300/12" hardened stainless steel rule, metric and inch measurements with graduations in 1.0mm and 1/32".

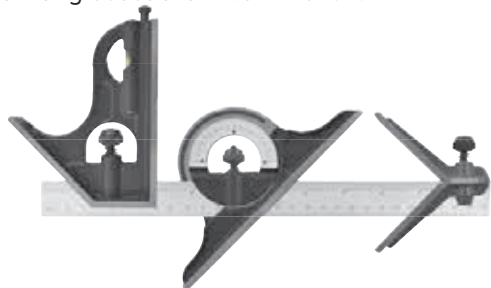

Order Code  
**KEN-330**  
**-3250K**

### Spares

Description	Order Code
	<b>KEN-330</b>
Square Head	<b>-3260K</b>
Centre Head	<b>-3270K</b>
Protractor Head	<b>-3280K</b>
12"/300mm Rule	<b>-3290K</b>

## OXFORD PRECISION Bevel Protractor Set

Made of polished and hardened stainless steel with magnifying lens for easy reading of vernier scale.

Range is 4x 90° and accuracy is +1/2° or 5 minutes.

### Set includes:

protractor head, 150mm (6"), 200mm (8") & 300mm (12") plain rules, height gauge and acute angle attachments.

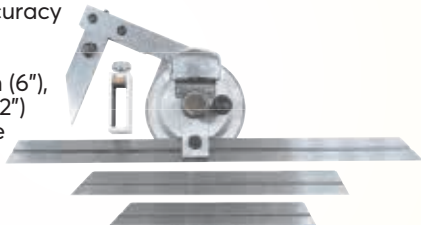

Order Code  
**OXD-330**  
**-9500K**

## OXFORD PRECISION Dual Counter Height Gauges

Used in conjunction with a granite or metal surface plate, the Oxford dual counter height gauge will give you the accuracy you need when laying out work prior to machining. The height gauge can also be used in much the same way as a caliper to help you determine the dimensions of a workpiece.

- Designed for accurate marking out and taking precise measurements.
- Measuring head positioned on sturdy twin columns providing highly repeatable height measurements and stability.
- Easy reading with dual directional negative and positive reading mechanical digital counters.
- Rotating dial face.
- Independently set the counters, to zero at any position.
- Large feed wheel for rapid and precise adjustment.
- Tungsten carbide tipped scriber for accurate marking out.
- Manufactured from durable stainless steel.



**Reading**  
Inch:  
0.001"/0.1"  
Metric:  
0.01mm/  
1mm



Range	Product Number	Range/Rev	Weight each	Order Code
300mm	DHG000	1mm	4.25kg	<b>-3620K</b>
600mm	DHG000	1mm	10kg	<b>-3740K</b>

# Dial Thickness Gauges/Dial Calipers



## Leg Type Dial Calipers

Used for measuring diameters and narrow grooves in hard to reach places.

**Internal specifications:** range: 55 - 75mm, graduation: .01mm, groove depth: 8mm, groove width: 3mm, maximum reach: 100mm.

**External specifications:** range: 0 - 20mm, graduation: 0.01mm, groove depth: 6mm, groove width: 3mm, throat depth: 60mm.

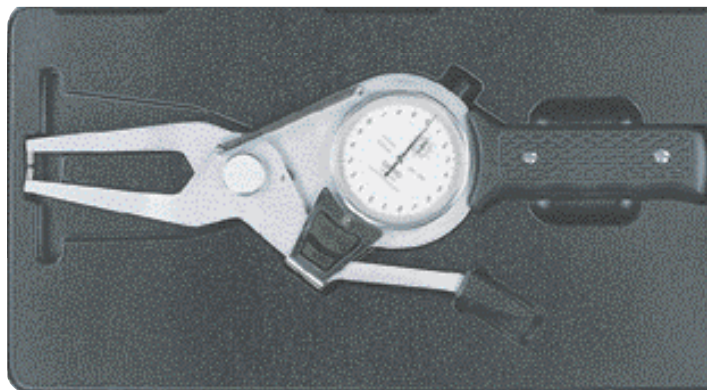

Type	Groove Depth	Reach/Depth	Order Code
External	6mm	60mm	<b>-0600K</b>
Internal	8mm	100mm	<b>-0750K</b>

## Dial Thickness Gauge

For quickly measuring the thickness of paper, film, leather, rubber etc. The spindle is moved using the thumb lever. With adjustable bezel. Measuring faces are made of high grade tool steel, hardened, ground and lapped for accuracy.

Thumb lever raises spindle to allow for workpiece insertion.

**Range:** 0 - 10mm.

**Resolution:** 0.01mm.

**Throat depth:** 30mm.

**Accuracy:** ±0.02mm.



Type	Groove Depth	Reach/Depth	Weight each	Order Code
External	6mm	60mm	236g	<b>-0100K</b>



## Dial Calipers

Rack covers prevent dust from fouling teeth of racks. All measuring faces are precision ground and micro lapped for absolute inside, outside, depth and step readings. Manufactured to DIN 862.

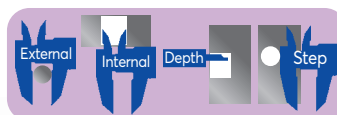

Range	Resolution	Accuracy (mm)	Weight each	Order Code
150mm	0.05mm	±.05mm	320g	<b>-1160K</b>



## Dial Calipers

Rack covers prevent dust from fouling teeth of racks. All measuring faces are precision ground and micro lapped for absolute inside, outside, depth and step readings. Manufactured to DIN 862.

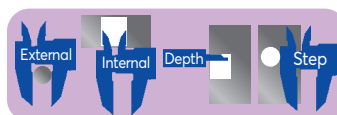

Range	Resolution	Accuracy (mm)	Weight each	Order Code
12"	0.001"	±.002"	570g	<b>-6120K</b>
150mm	0.05mm	±.05mm	320g	<b>-6150K</b>
200mm	0.05mm	±.05mm	530g	<b>-6200K</b>
300mm	0.05mm	±.05mm	750g	<b>-6300K</b>

# Vernier Calipers



## Fine Adjustment Vernier Calipers

Incorporating Quadri feature - gives outside, inside, depth and step readings. Fine adjustment feature allows improved sensitivity of slider movement. 14° vernier face angle reduces parallax. Satin chrome finish with clear easy read graduations.

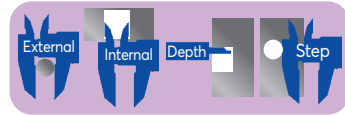
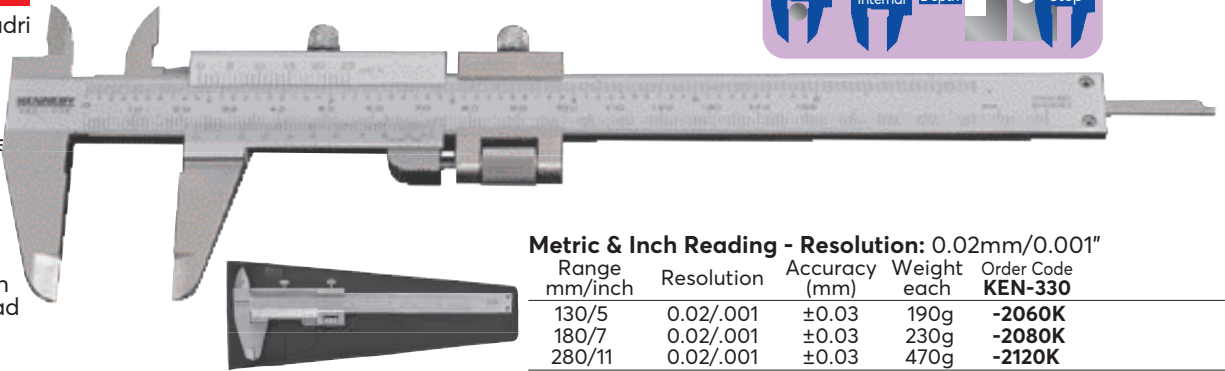

**Metric & Inch Reading - Resolution: 0.02mm/0.001"**

Range mm/inch	Resolution	Accuracy (mm)	Weight each	Order Code
130/5	0.02/.001	±0.03	190g	<b>-2060K</b>
180/7	0.02/.001	±0.03	230g	<b>-2080K</b>
280/11	0.02/.001	±0.03	470g	<b>-2120K</b>



## Standard Vernier Calipers

Give four types of reading - inside, outside, depth and step. Dual reading scale (metric and inch) with 14° bevelled vernier scale for reduced parallax reading error and knurled locking nut. Manufactured from hardened stainless steel for rigidity. Satin finish. Conform to **DIN 862**.

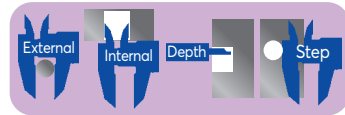
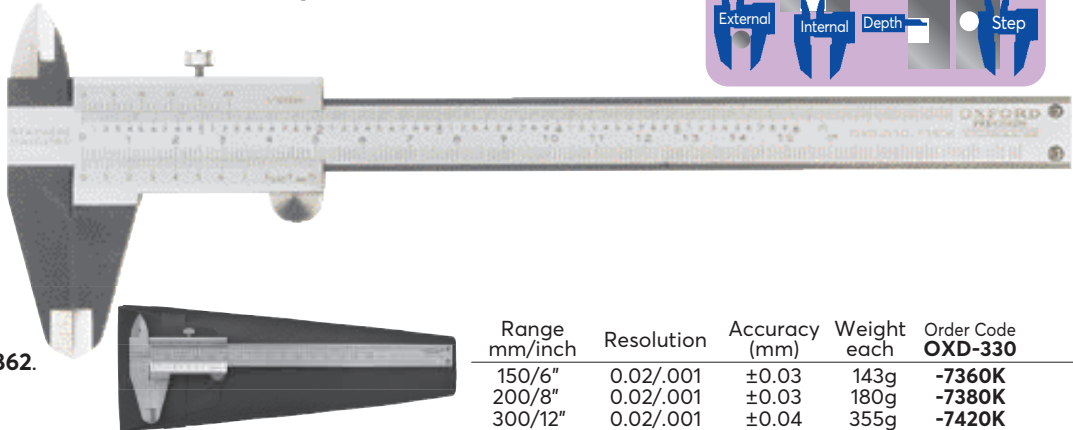

Range mm/inch	Resolution	Accuracy (mm)	Weight each	Order Code
150/6"	0.02/.001	±0.03	143g	<b>-7360K</b>
200/8"	0.02/.001	±0.03	180g	<b>-7380K</b>
300/12"	0.02/.001	±0.04	355g	<b>-7420K</b>

## Fine Adjustment Vernier Calipers

Give four types of reading, inside, outside, depth and step. Dual reading scale (metric and inch) with 14° bevelled vernier scale for reduced parallax reading error, fine adjustment assembly and knurled locking nut. Manufactured from hardened stainless steel for rigidity with satin finish. Conforms to **DIN 862**.

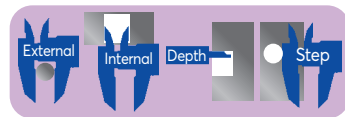
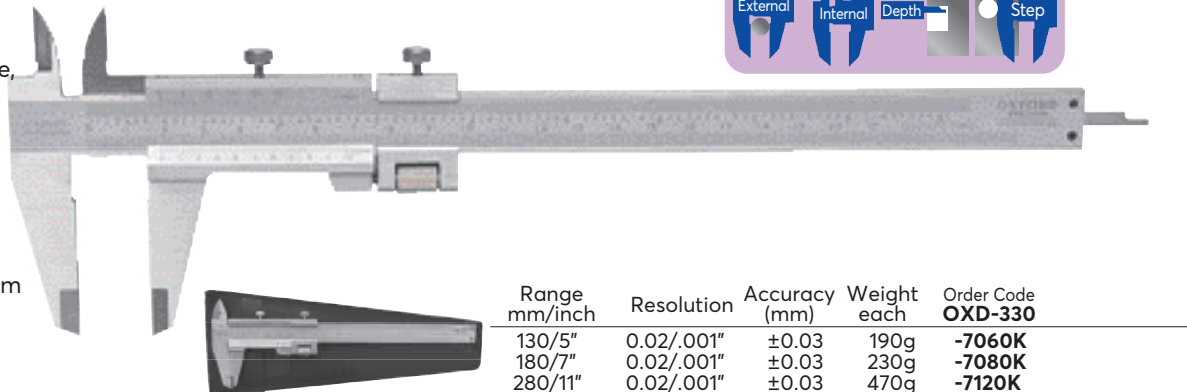

Range mm/inch	Resolution	Accuracy (mm)	Weight each	Order Code
130/5"	0.02/.001"	±0.03	190g	<b>-7060K</b>
180/7"	0.02/.001"	±0.03	230g	<b>-7080K</b>
280/11"	0.02/.001"	±0.03	470g	<b>-7120K</b>

## Heavy Duty Vernier Calipers

Give inside and outside readings. Dual reading scale (metric and inch) with 14° bevelled vernier scale for reduced parallax reading error, fine adjustment assembly and knurled locking nut. Internal reading edges have rounded faces for accurate bore measurement. Manufactured from hardened stainless steel.

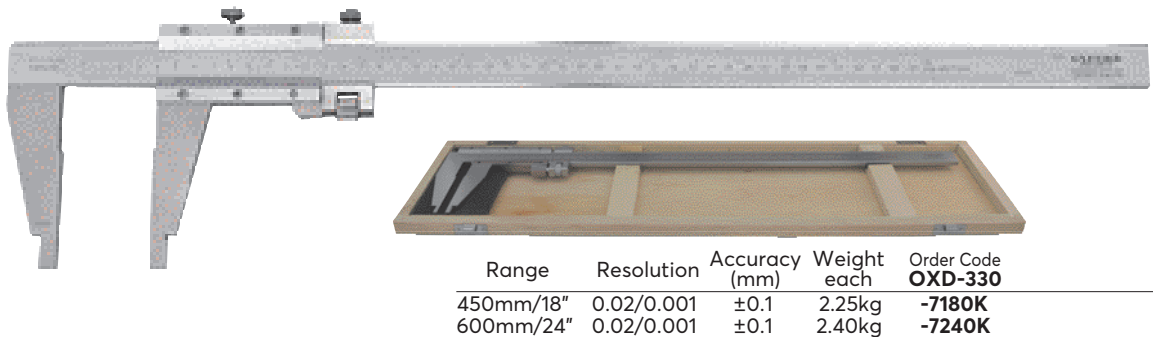

Range	Resolution	Accuracy (mm)	Weight each	Order Code
450mm/18"	0.02/0.001	±0.1	2.25kg	<b>-7180K</b>
600mm/24"	0.02/0.001	±0.1	2.40kg	<b>-7240K</b>

## Depth Gauge Attachment

Stainless steel depth gauge attachment for use with 150 and 200mm (6" and 8") depth gauges. 16mm vernier recess width with knurled locking nut.

Size	Models suited (mm)	Weight each	Order Code
75mm	150/200	45g	<b>-9600K</b>

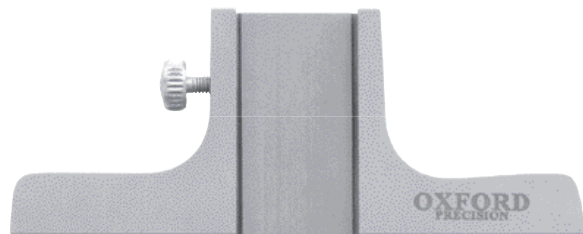

**SENATOR**  
QUALITY TOOLING

**Digital Calipers**

Large display for clarity. Fast response speed. Zero reset. Dual readout mm/ inch. Knurled thumb grip for precise movement.

**Conforms to:**  
EN 61000-6-3:2007  
EN 61000-6-1:2007

**Resolution:**  
0.01mm/0.0005"  
**Accuracy:**  
±0.03mm/±0.001"

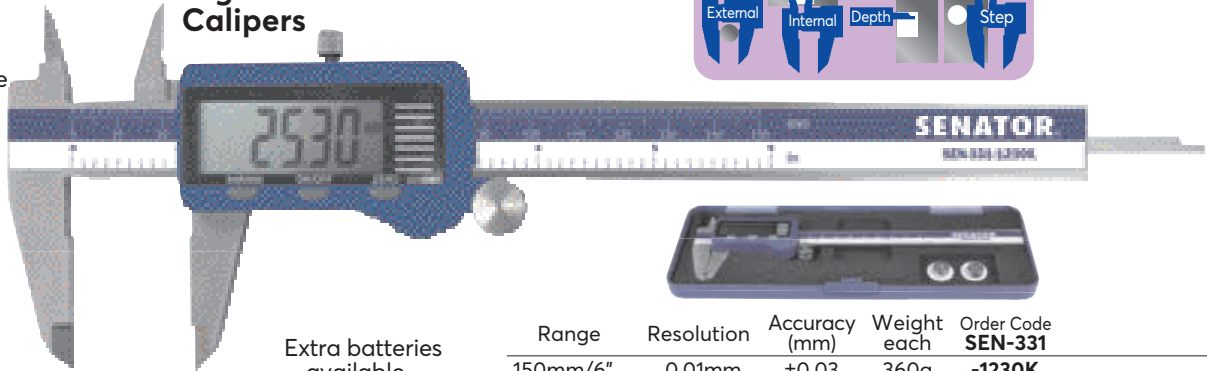

Extra batteries available -  
Order Code  
**EDI-904-4000K.**

Range	Resolution	Accuracy (mm)	Weight each	Order Code <b>SEN-331</b>
150mm/6"	0.01mm	±0.03	360g	<b>-1230K</b>
200mm/8"	0.01mm	±0.03	425g	<b>-1250K</b>
300mm/12"	0.01mm	±0.03	805g	<b>-1290K</b>

**Polycal Digital Caliper**

For taking outside, inside, step and depth measurements. Measurement conversion in inches, millimetres and fractions. Uses one CR2032 3V battery. Conforms to **EN 61000-6-3: 2007** and **EN 61000-6-1:2007.**

**Measuring range:**  
0-150mm/0-6"  
**Resolution:**  
0.01mm/0.0005"  
**Accuracy:**  
±0.02mm/±0.008"

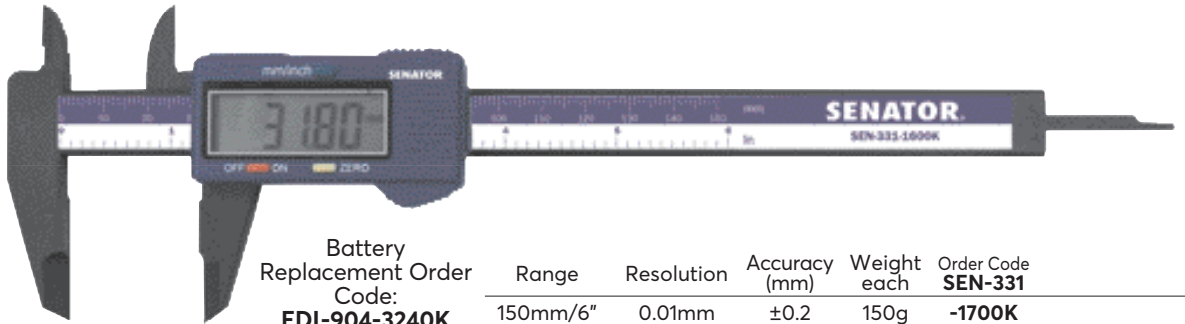

Battery Replacement Order Code:  
**EDI-904-3240K**

Range	Resolution	Accuracy (mm)	Weight each	Order Code <b>SEN-331</b>
150mm/6"	0.01mm	±0.2	150g	<b>-1700K</b>

**KENNEDY**  
QUALITY INDUSTRIAL TOOLING

**ABSolute Digital Electronic Calipers**

Modern design with a knurled thumb wheel for easy use when taking internal and external depth and step measurements. Dual readout giving instant inch/metric conversion at the touch of a button. Zero reset at any point, large clear display, error-free operation, fast response speed. Non-output type.

**Resolution:** 0.01mm/0.0005".

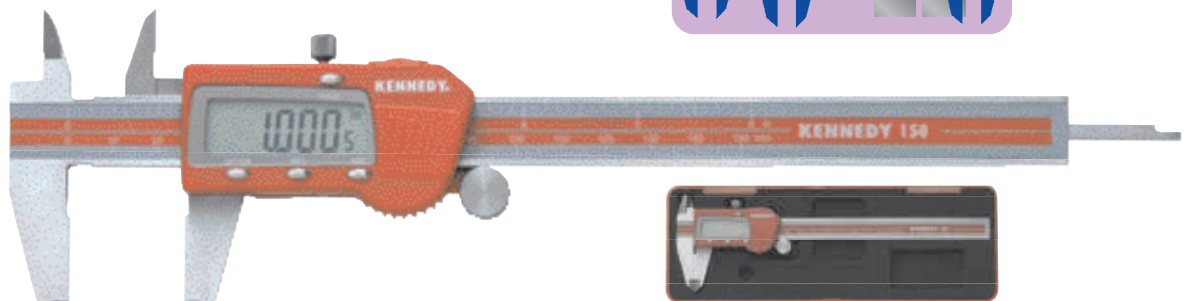

Extra batteries available -  
Order Code  
**EDI-904-4000K.**

Range	Resolution	Accuracy (mm)	Weight each	Order Code <b>KEN-331</b>
150mm/ 6"	0.01mm	±0.03	360g	<b>-2260K</b>
200mm/ 8"	0.01mm	±0.03	425g	<b>-2280K</b>
300mm/12"	0.01mm	±0.03	805g	<b>-2320K</b>

**OXFORD**  
PRECISION

**Precision ABS Digital Calipers**

Precision ABSolute digital calipers have a thumb wheel for precise movement and a useful locking screw for checking repeat measurements. A measurement can be converted between inch/metric at the touch of a button. Non-output type.

**ABSolute Measurement Function -**  
The zero point once set is fixed until changed, even if the caliper is turned off (unless the battery is removed). Incremental mode can be achieved for repeated use of Go/No-Go measurement.

**Resolution:**  
0.01mm/0.0005".

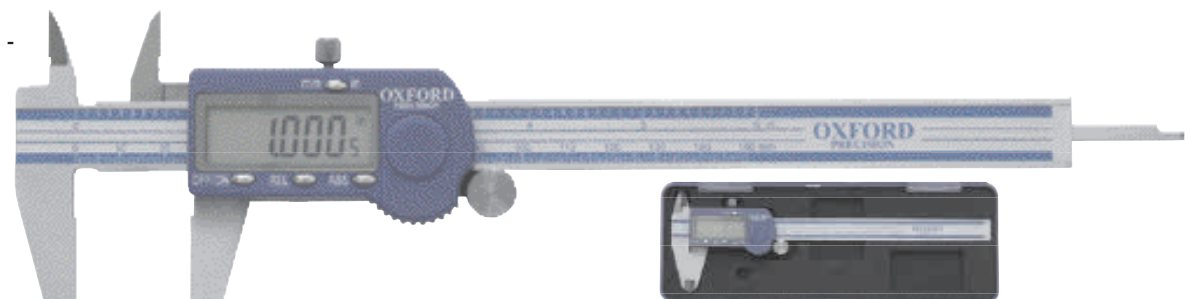

Extra batteries available -  
Order Code  
**EDI-904-4000K.**

Range	Resolution	Accuracy (mm)	Weight each	Order Code <b>OXD-331</b>
150mm/ 6"	0.01mm	±0.03	360g	<b>-2260K</b>
200mm/ 8"	0.01mm	±0.03	460g	<b>-2280K</b>
300mm/12"	0.01mm	±0.03	810g	<b>-2320K</b>





## Coolant-Proof IP67 Digital Caliper

Available in a range of sizes, this digital caliper is coolant, water and dust proof to IP67 level. It has a large LCD display, fast response speed, dual readout (mm/inch) and can be used for inside, outside, depth and step measuring. Also enables absolute and relative reading.

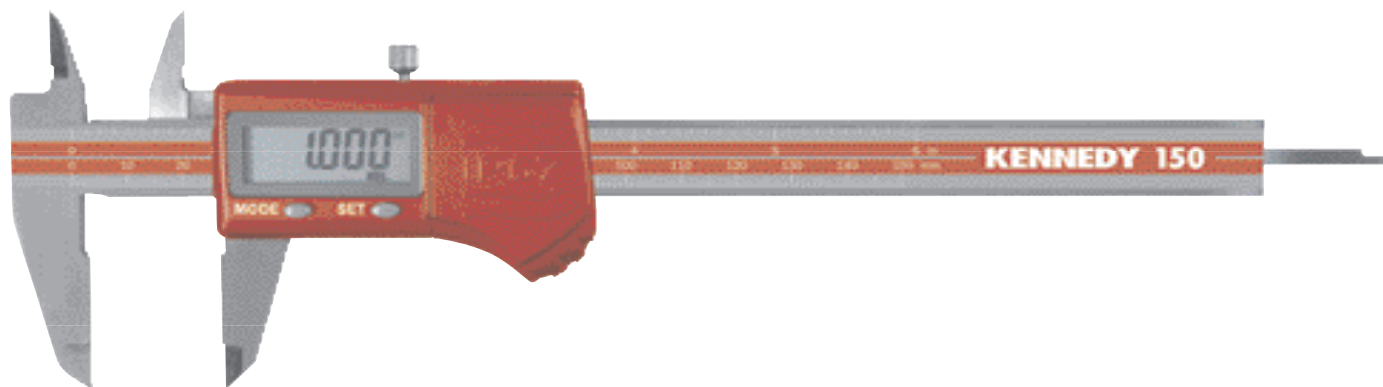
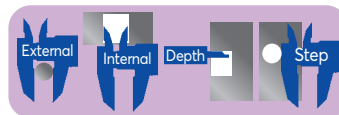

Extra batteries available - Order Code **EDI-904-4000K**.

Range	Accuracy (mm)	Weight each	Order Code
150mm/6"	±0.03	400g	<b>-1200K</b>
200mm/8"	±0.03	500g	<b>-2270K</b>
300mm/12"	±0.04	750g	<b>-2310K</b>



## Digital Depth Gauge

Easy handling with mm/inch measurement, large digital display. External readings with zero set at any point fitted with a thumb wheel for greater accuracy.



Protected against dust ingress and fluid splash

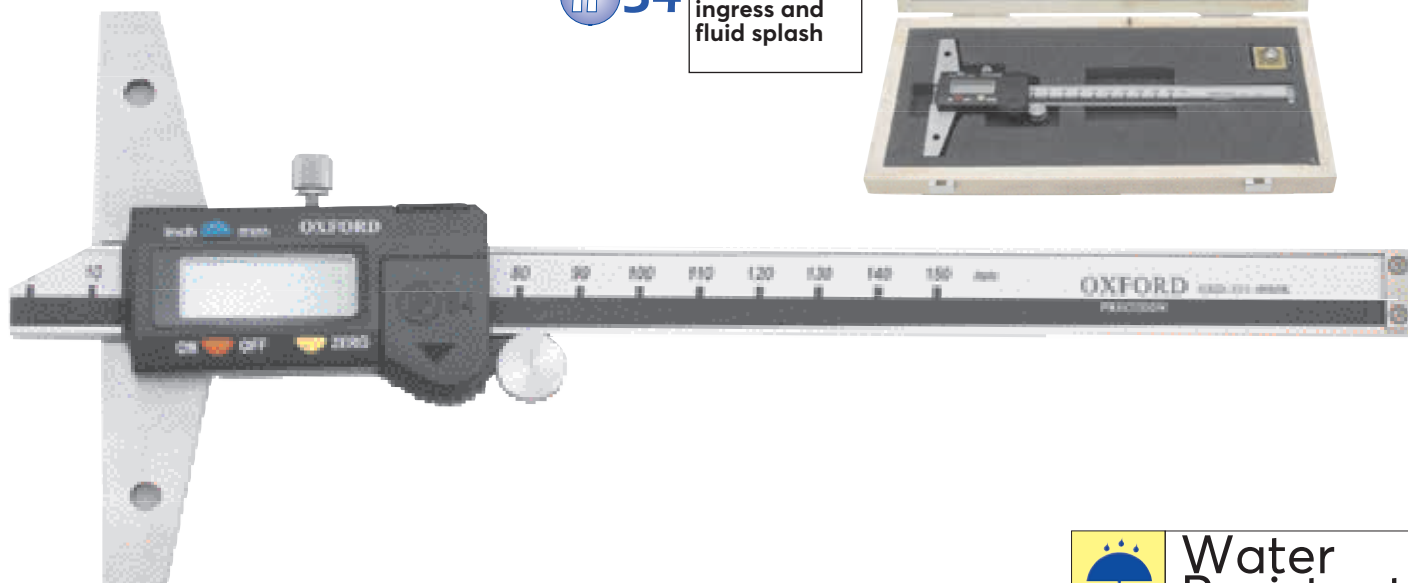

**inch mm CONVERTIBLE**   **ZERO RESET**   **READING .01mm .0005"**   **SPARE BATTERY**

Range	Order Code
0 - 150mm/6" Digital Depth Gauge	<b>OXD-331</b> <b>-4060K</b>

## OXFORD PRECISION Digital External Micrometers

Featuring large digital display and carbide tipped measuring faces. With ball end cap for measuring curved surfaces, auto power on/off and mm/inch conversion. Ratchet stop for consistent measurement and locking device. Complete with case, spanner and battery.



### IP65

Range	Order Code
0-25mm/0-1"	<b>-3500K</b>
25-50mm/1-2"	<b>-3510K</b>
50-75mm/2-3"	<b>-3520K</b>
75-100mm/3-4"	<b>-3530K</b>

### IDM Digital Indicator

**Features:** Easy to use with clear digital LCD display. Large, easy-read 7.5mm LCD display. Soft-key touch for operator comfort, superior construction quality.

**Response speed:** ≤0.5m/s.  
Auto power off.

#### Type IDM

Inch/metric conversion, zero reset, data hold, min. max display, fast display, auto power off.



### IP54

Protected against dust ingress and fluid splash



Order Code  
**OXD-331**  
**-6020K**

<b>inch mm</b> CONVERTIBLE	<b>TRAVEL</b> 12.7mm 0.5"
<b>ZERO RESET</b>	<b>READING</b> 0.001mm 0.00005"

### Digital M/F Indicator

Large, easy-read 7.5mm LCD display. Inch/mm convertible. ZERO reset button. Absolute measuring / Relative reading. Auto power off.

**Response speed:** 0.5m/s.

**Travel:** 12.7mm/0.5".

**Resolution:** 0.01mm / 0.00005".



Range	Order Code
0-12.7mm/0-0.5"	<b>OXD-331</b> <b>-6040K</b>



## Permanent Mag Stand

### Mini-Mag Stand

With one magnetic face. Light duty with standard clamp, 30mm diameter keeper.

**Mounts:**

1/4" I/D lug, stem/spigot diameter: 5/16".

**Column height x dia.:**

120 x 6.3mm.

**Clamp hole:** 8mm.

**Magnetic pull:** 14.75kg.

**Base dimensions:** 30 x 35mm.



Overall Height	Weight each	Order Code
150mm	320g	<b>KEN-333</b> -2010K

## Lever Switchable Universal 2 Mag Stand

With two magnetic faces and large vee. Heavy duty with universal clamp.

**Mounts:**

1/4" I/D lug, stem/spigot diameter:

4mm, 8mm, 3/8" without bush.

**Column height x dia.:**

175 x 12mm.

**Crossbar length x dia.:**

165 x 10mm.

**Clamp ring:** 6.35mm.

**Magnetic pull:** 50kg.

**Base dimensions:** 60 x 50 x 55mm.



Overall Height	Weight each	Order Code
230mm	1.2kg	<b>KEN-333</b> -2030K

## Lever Switchable Fine Adjustable 2 Mag Stand

With two magnetic faces and large vee. Heavy duty with universal clamp and fine adjustment.

**Mounts:**

1/4" I/D lug, stem/spigot diameter:

4mm, 8mm, 3/8" without bush.

**Base dimensions:**

60 x 50 x 55mm.

**Column height x dia.:**

175 x 12mm.

**Crossbar length x dia.:**

165 x 10mm.

**Clamp ring:** 6.35mm.

**Magnetic pull:** 50kg.

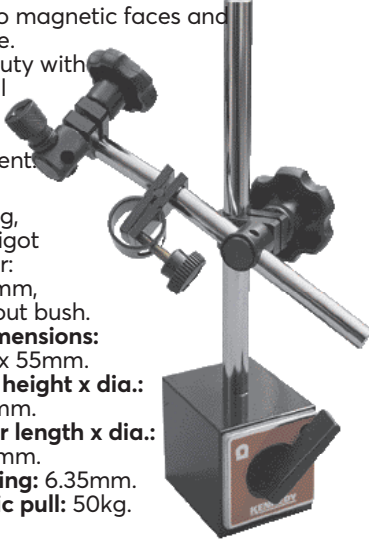

Overall Height	Weight each	Order Code
230mm	1.2kg	<b>KEN-333</b> -2050K

## Universal 2 Mag Stand

Lever type, two magnetic faces and large vee. With universal clamp.

**Mounts:**

1/4" I/D lug, stem/spigot diameter:

4mm, 8mm, 3/8" without bush.

**Base dimensions:**

60 x 50 x 55mm.

**Column height x dia.:**

175 x 12mm.

**Crossbar length x dia.:**

165 x 10.0mm.

**Clamp ring:** 6.35mm.

**Magnetic pull:** 50kg.

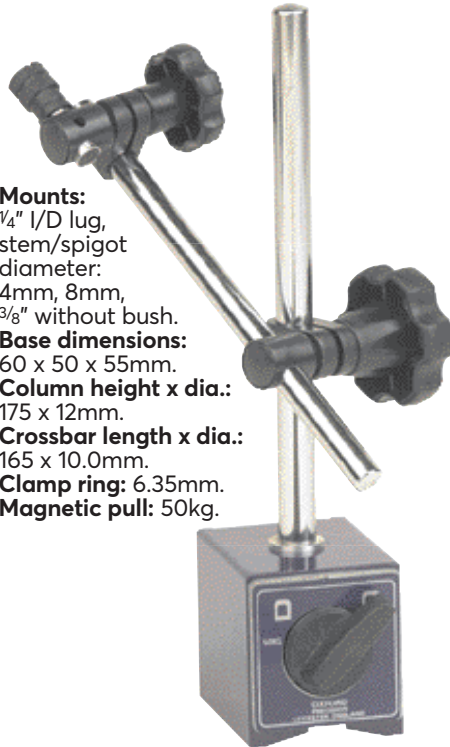

Overall Height	Weight each	Order Code
230mm	1.20kg	<b>OXD-333</b> -7030K

## Fine Adjustment 2 Mag Stand

Lever type two magnetic faces and large vee. Universal clamp.

**Mounts:**

1/4" I/D lug, stem/spigot diameter:

4mm, 8mm, 3/8" without bush.

**Base dimensions:**

60 x 50 x 55mm.

**Column height x dia.:**

175 x 12mm.

**Crossbar length x dia.:**

150 x 10.0mm.

**Clamp ring:** 6.35mm.

**Magnetic pull:** 50kg.

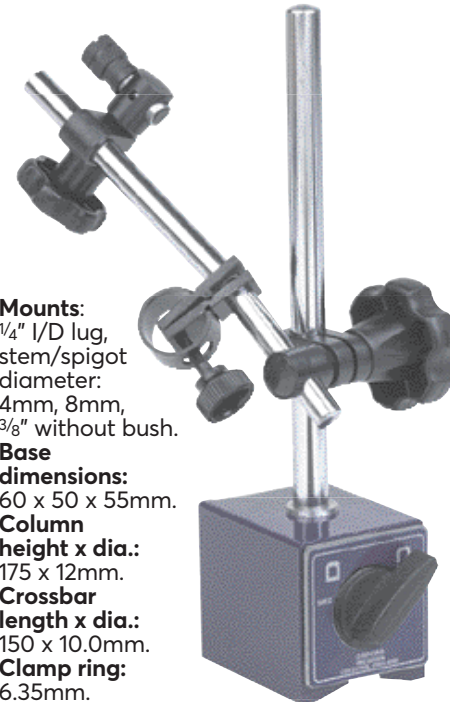

Overall Height	Weight each	Order Code
230mm	1.20kg	<b>OXD-333</b> -7050K

## Universal 4 Mag Stand

With four magnetic faces, one at 45°. Universal clamp.

**Mounts:**

1/4" I/D lug, stem/spigot diameter: 1/8", 5/16" and 3/8".

**Base dimensions:**

48 x 44 x 51mm.

**Column height x dia.:**

175 x 12mm.

**Crossbar x dia.:**

165 x 10.0mm.

**Clamp ring:** 6.35mm.

**Magnetic pull:** 30kg.

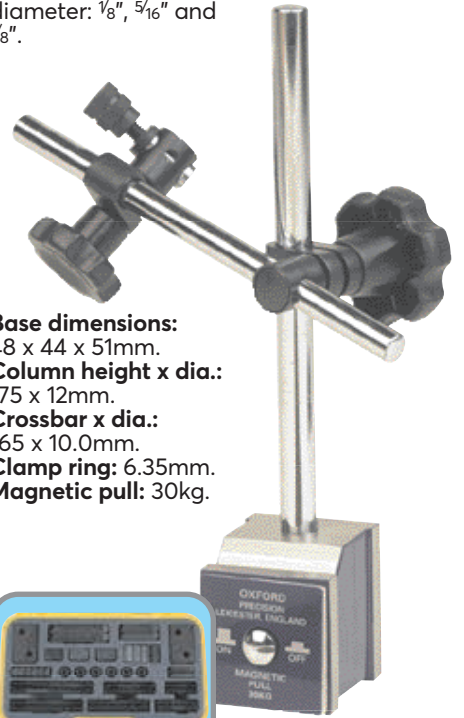

Overall Height	Weight each	Order Code
230mm	1.20kg	<b>OXD-333</b> -7100K

## Compact 4 Mag Stand

With four magnetic faces, one at 45°. Standard clamp.

**Mounts:**

1/4" I/D lug, stem/spigot diameter: 5/16".

**Base dimensions:**

48 x 44 x 51mm.

**Column height x dia.:**

185 x 12mm.

**Crossbar length x dia.:**

165 x 6.3mm.

**Clamp ring:** 8mm.

**Magnetic pull:** 30kg.

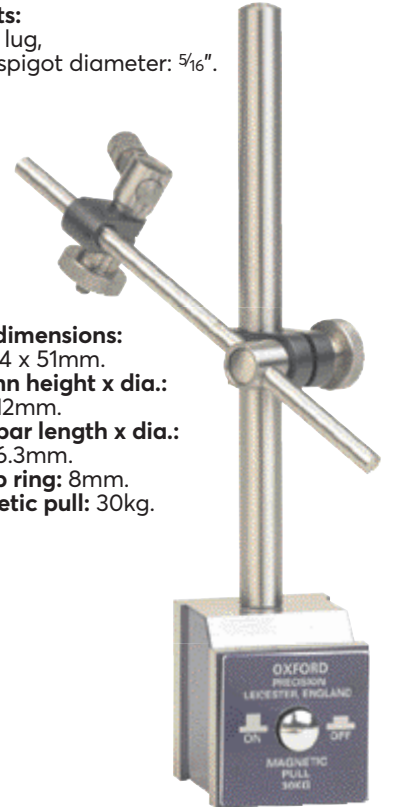

Overall Height	Weight each	Order Code
280mm	1.90kg	<b>OXD-333</b> -7080K



## Lever Switchable Mini Elbow Joint 2 Mag Stand

Compact in design, this stand has a magnetic pull of 30kg with positive switching, fully adjustable joints and slotted 'V' groove.

**Mounts:** 1/4" I/D lug, dovetail stem/spigot diameter: 5/16".  
**Base dimensions:** 36 x 30 x 35mm.  
**Column height x diameter:** Up to 150 x 12mm.  
**Magnetic pull:** 30kg.



Mini Elbow Joint	Weight each	Order Code
2 Mag	420g	<b>KEN-333</b> <b>-2140K</b>

## Lever Switchable Elbow Joint 2 Mag Stand

With two magnetic faces and large vee. Medium duty special clamp with fine adjustment.

**Mounts:** 1/4" I/D lug, dovetail stem/spigot diameter: 5/16".  
**Base dimensions:** 60 x 50 x 55mm.  
**Column height x diameter:** Up to 280 x 15mm.  
**Clamp ring:** 6.35mm.  
**Magnetic pull:** 50kg.



Elbow Joint	Weight each	Order Code
2 Mag	1.2kg	<b>KEN-333</b> <b>-2110K</b>

## Lever Switchable Large Elbow Joint 2 Mag Stand

Large stand with two powerful magnetic faces producing a magnetic pull of 80kg. Positive switching, fully adjustable joints and slotted 'V' groove for versatility.

**Mounts:** 1/4" I/D lug, dovetail stem/spigot diameter: 5/16".  
**Base dimensions:** 60 x 50 x 55mm.  
**Column height x diameter:** Up to 300 x 17mm.  
**Magnetic pull:** 80kg.



Large Elbow Joint	Weight each	Order Code
2 Mag	1.62kg	<b>KEN-333</b> <b>-2150K</b>

## KENNEDY Surface Gauges

Used for marking out lines parallel to a true edge or groove, and also to mark the centre of round bars. Machined base, two pillars, a double ended scriber and an adjustable attachment for holding scribes up to 1/4" diameter on to the pillar. The base has a machined V-groove for use on pipes and round bar and two frictionally held pins which are used as a guide when sliding along the true edge or groove. The angle of the pillar can be finely adjusted with the use of a knurled thumb screw. Supplied with two pillars.

**Base dimensions:** 80 x 30mm.



Pillar Height (mm)	Order Code
230 & 305	<b>KEN-518</b> <b>-4300K</b>



## Major 4 Mag Stand

With four magnetic faces, one at 45°. Heavy duty with universal clamp.

**Mounts:**  
1/4" I/D lug, stem/spigot diameter: 1/4", 5/16".

**Base dimensions:**  
64 x 64 x 76mm.

**Column height x diameter:**  
266 x 20mm.

**Crossbar length x diameter:**  
200 x 14.0mm.

**Magnetic pull:** 80kg.

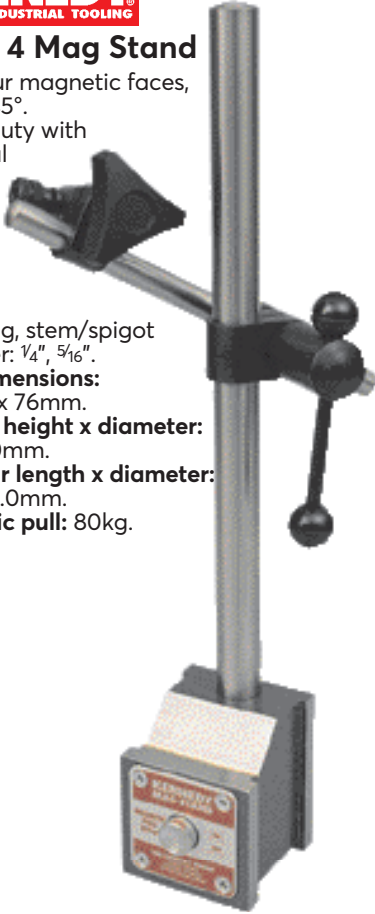

Overall Height	Weight each	Order Code KEN-333
380mm	3.00kg	-2070K

## Fine Adjusting 4 Mag Stand

With four magnetic faces, one at 45°. Heavy duty with universal clamp and fine adjustment.

**Mounts:**  
1/4" I/D lug, stem/spigot diameter: 1/8", 1/4".

**Base dimensions:**  
64 x 64 x 76mm.

**Column height x diameter:**  
175 x 12mm.

**Crossbar length x diameter:**  
165 x 10.0mm.

**Magnetic pull:** 80kg.



Overall Height	Weight each	Order Code KEN-333
280mm	1.90kg	-2060K

## Universal 4 Mag Stand

With four magnetic faces, one at 45°. Heavy duty with universal clamp.

**Mounts:**  
1/4" I/D lug, stem/spigot diameter: 1/8", 5/16" and 3/8".

**Base dimensions:**  
48 x 44 x 51mm.

**Column height x diameter:**  
175 x 12mm.



**Crossbar length x diameter:**  
165 x 10.0mm.

**Clamp ring:** 8mm.  
**Magnetic pull:** 30kg.

Overall Height	Weight each	Order Code KEN-333
227mm	0.90kg	-2100K

## Compact 4 Mag Stand

With four magnetic faces, one at 45°. Medium duty with standard clamp.

**Mounts:**  
1/4" I/D lug, stem/spigot diameter: 5/16".

**Base dimensions:** 48 x 44 x 51mm.



**Column height x diameter:**  
185 x 12mm.  
**Crossbar length x diameter:**  
150 x 6.3mm.  
**Clamp ring:** 8mm.  
**Magnetic pull:** 30kg.

Overall Height	Weight each	Order Code KEN-333
273mm	0.89kg	-2080K

## Lever Type Base - 50kg

Fitted as standard to KEN-333-2030K, -2050K and -2110K two magnetic faces, bottom and back face.

Large vee for curved surfaces.

**Threaded:** M8 x 1.25mm.

**Base dimensions:** 60 x 50 x 55mm.

**Magnetic pull:** 50kg.



Weight each	Order Code KEN-333
850g	-2240K

## Push Button Base - 30kg

Fitted as standard to KEN-333-2080K and -2100K. Four magnetic faces, bottom, sides and 45° angle face for curved surfaces.

**Base dimensions:** 48 x 44 x 51mm.

**Threaded:** M8 x 1.25mm.

**Magnetic pull:** 30kg.



Weight each	Order Code KEN-333
850g	-2220K

## Push Button Base - 80kg

Fitted as standard to KEN-333-2060K and -2070K. Four magnetic faces, bottom, sides and 45° angle face for curved surfaces.

**Threaded:** M8 x 1.25mm.

**Magnetic pull:** 80kg.



Weight each	Order Code KEN-333
850g	-2200K



## Magnetic Stand Fitments

All main columns are threaded M8 x 1.25mm and are interchangeable with Kennedy, Oxford, Mitutoyo etc. base units except mini-mag (M6 x 1mm) also suitable for incorporating into special fixtures or threaded pot magnets.



### Light Duty Fitment - Plain

Fitted as standard to **KEN- 333-2010K**. (See page 250).

**Column:** 6.3 x 120mm.  
**Clamp hole:** 8mm.  
**Threaded:** M5.

6.3mm Standard Clamp To Suit	Weight each	Order Code
$\frac{1}{4}$ " I/D Lug, Stem/Spigot Dia. $\frac{5}{16}$ "	90g	<b>-2500K</b>

### Heavy Duty Fitment - Fine Adjusting

Fitted as standard to **KEN- 333-2060K** and **KEN- 333-2050K**. (See pages 252 and 250).



**Column:** 12 x 175mm.  
**Cross bar:** 10 x 150mm with fine adjustment.  
**Threaded:** M8 x 1.25mm.

10mm Universal Clamp To Suit	Weight each	Order Code
$\frac{1}{4}$ " I/D Lug, Stem/Spigot Dia. $\frac{1}{8}$ ", $\frac{1}{4}$ ", $\frac{5}{16}$ " & $\frac{3}{8}$ "	442g	<b>-2400K</b>

### Spare Knuckle Assemblies

For connecting columns and crossbars.

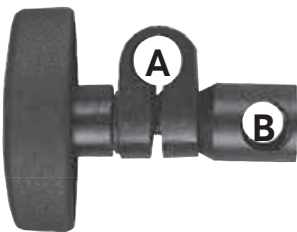

Accepts A & B (dia.)	Weight each	Order Code
12 & 10mm	60g	<b>-2920K</b>

### Medium Duty Fitment - Plain

Fitted as standard to **KEN- 333-2080K**. (See page 252).

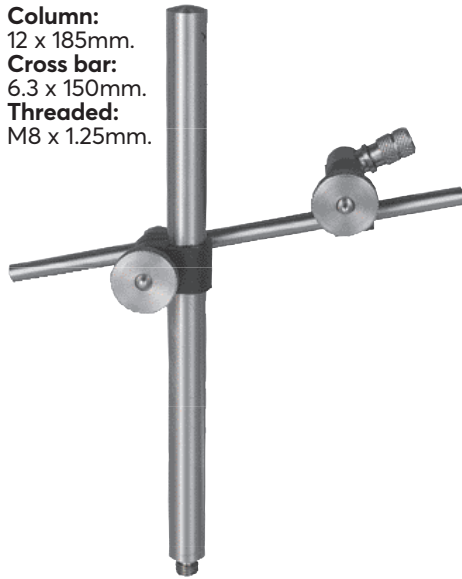

**Column:** 12 x 185mm.  
**Cross bar:** 6.3 x 150mm.  
**Threaded:** M8 x 1.25mm.

6.3mm Standard Clamp To Suit	Weight each	Order Code
$\frac{1}{4}$ " I/D Lug, Stem/Spigot Dia. $\frac{5}{16}$ "	420g	<b>-2460K</b>

### Heavy Duty Fitment - Plain

Fitted as standard to **KEN- 333-2100K** and **KEN-333-2030K**. (See pages 252 and 250).

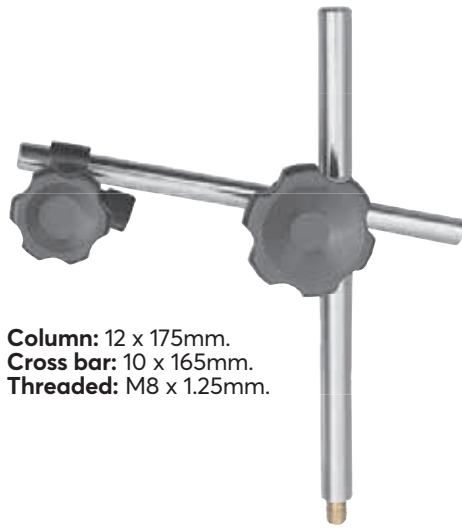

**Column:** 12 x 175mm.  
**Cross bar:** 10 x 165mm.  
**Threaded:** M8 x 1.25mm.

10mm Universal Clamp To Suit	Weight each	Order Code
$\frac{1}{4}$ " I/D Lug, Stem/Spigot Dia. $\frac{1}{8}$ ", $\frac{1}{4}$ ", $\frac{5}{16}$ " & $\frac{3}{8}$ "	400g	<b>-2420K</b>

### Crossbar Assemblies

With lug adaptor.  $\frac{1}{4}$ " I/D lug.

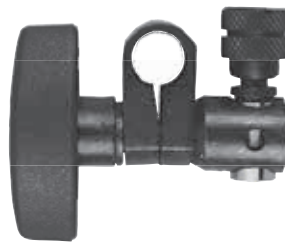

Accepts	Weight each	Order Code
4 & 10mm Spigot To Fit 10mm Bar	85g	<b>-3020K</b>
4 & 8mm Spigot To Fit 12mm Bar	85g	<b>-3040K</b>

### Medium Duty Fitment - 3 Point

Fitted as standard to **KEN- 333-2110K**. (See page 251).

**3 point adjustable column:** 15 x 280mm max.  
**Clamp hole:** 8mm.  
**Threaded:** M8 x 1.25mm.

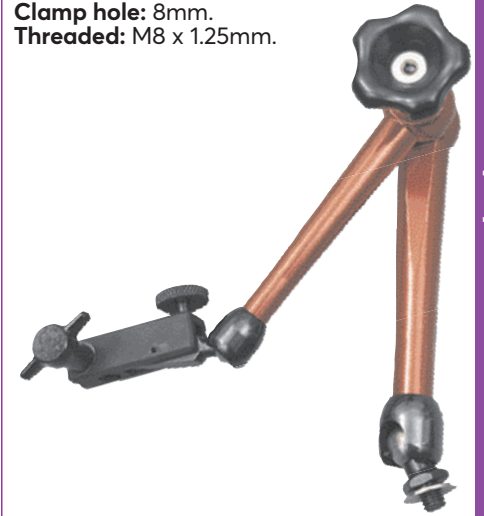

3 Point Special Clamp To Suit	Weight each	Order Code
$\frac{1}{4}$ " I/D Lug, Dovetails Stem/Spigot Dia. $\frac{5}{16}$ "	312g	<b>-2480K</b>

### Heavy Duty Fitment - Plain

Fitted as standard to **KEN- 333-2070K**. (See page 252).



**Column:** 20 x 266mm.  
**Cross bar:** 12 x 200mm.  
**Threaded:** M8 x 1.25mm.

14mm Universal Clamp To Suit	Weight each	Order Code
$\frac{1}{4}$ " I/D Lug, Stem/Spigot Dia. $\frac{1}{8}$ ", $\frac{1}{4}$ ", $\frac{5}{16}$ " & $\frac{3}{8}$ "	1450g	<b>-2440K</b>

### Crossbar Assemblies

With lug adaptor.  $\frac{1}{4}$ " I/D lug.



Accepts	Weight each	Order Code
$\frac{5}{16}$ " & $\frac{1}{4}$ " Spigot To Fit 10mm Bar	50g	<b>-3000K</b>

## OXFORD PRECISION 3 Point Bore Micrometer Sets

Designed to self-centre, for accurate measuring of bores. Satin finish, fitted with knurled ratchet stop.

Micrometers: 11 - 14mm, 14 - 17mm, 17 - 20mm.  
 Calibration ring: 11 and 17mm, slotted screwdriver and spanners x2.

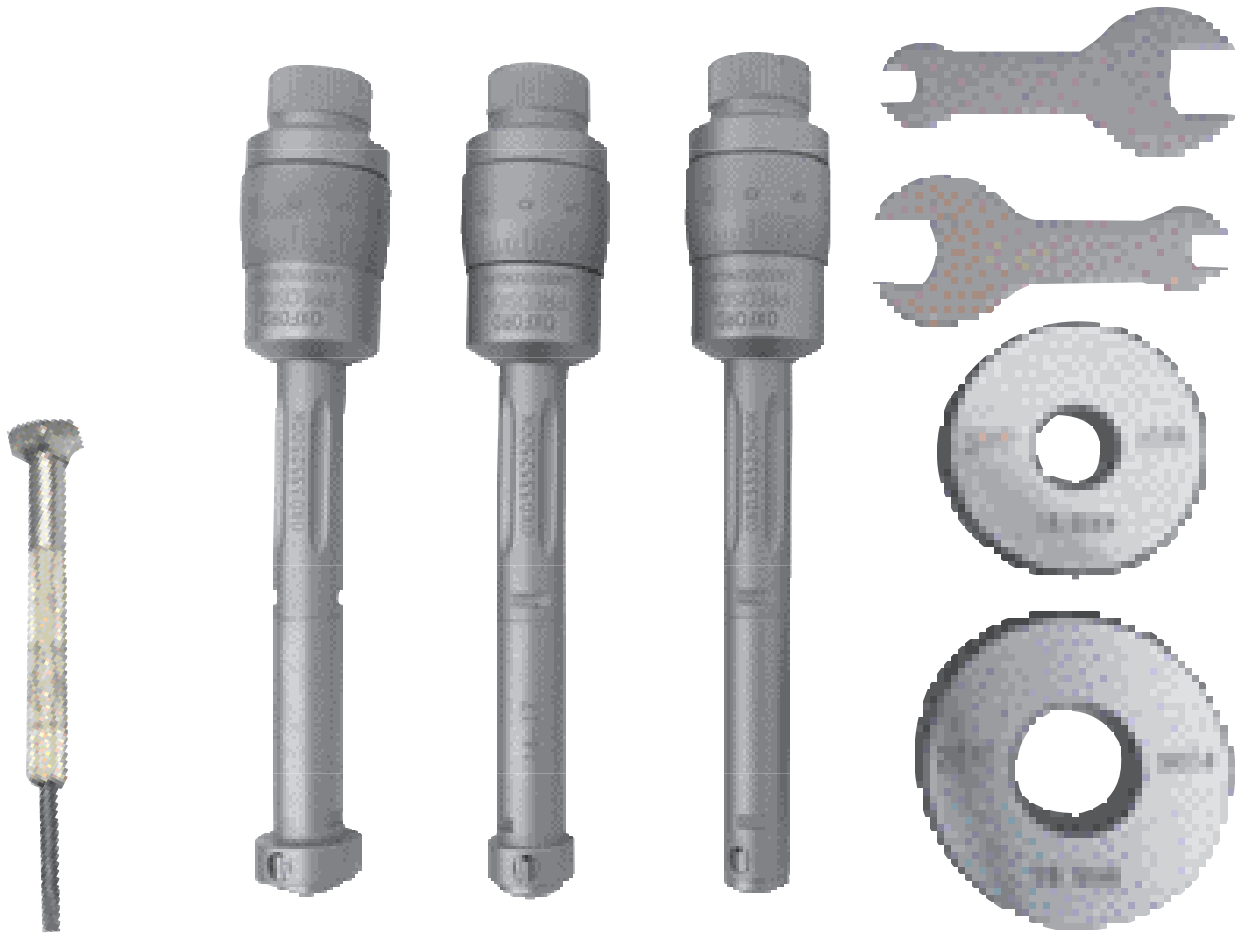

Micrometers: 20 - 25mm, 25 - 30mm, 30 - 35mm, 35 - 40mm.  
 Calibration ring: 25 and 35mm, slotted screwdriver and spanners x2.

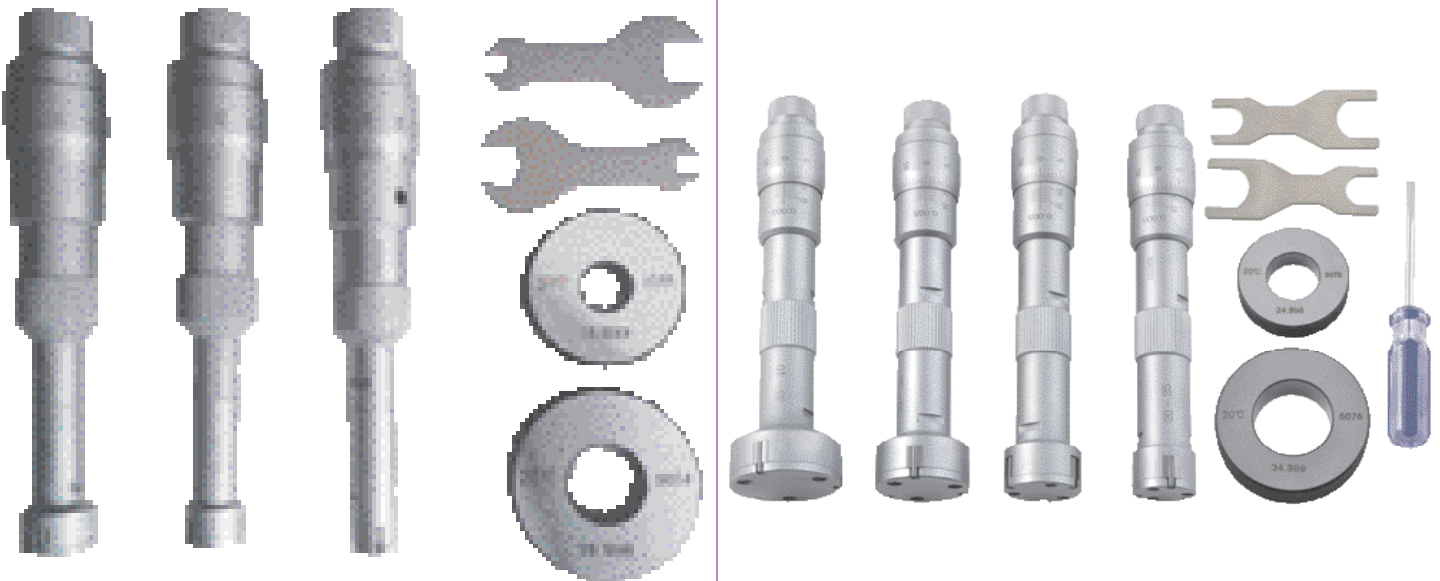

Range (mm)	Number of Micrometers	Weight each	Order Code
11 - 20mm	3	1.05kg	<b>OXD-335</b> <b>-2520K</b>

Range (mm)	Number of Micrometers	Weight each	Order Code
20 - 40mm	4	2.60kg	<b>OXD-335</b> <b>-2530K</b>

## OXFORD PRECISION Dial Indicating Bore Gauges

### 29mm 1 1/8" Dial Diameter

Suitable for rapid, accurate measurement of size, concentricity, wear, taper, etc., in a wide range of bores. For workshop and inspection use. All models have one fixed and one moving anvil and a self-adjusting centre shoe. A 'datum point' can be set by using a setting ring of a known diameter or a micrometer. 'Zero' the gauge to this datum point by rotating the bezel to align 'zero' with the indicator. To check a bore is within tolerance, the limit hands can be fixed as required. All anvils are spring loaded to expand into the bore. For accurate reading ensure the stem of the gauge is parallel to the axis of the bore. This can be checked by 'rocking' the gauge back and forth until the smallest diameter is found. All models have inter-changeable anvils to cover a range of bore sizes.

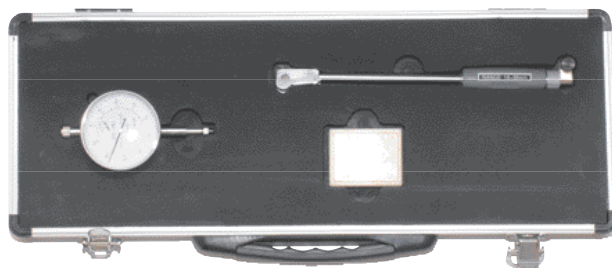

Supplied in a tough hard case.

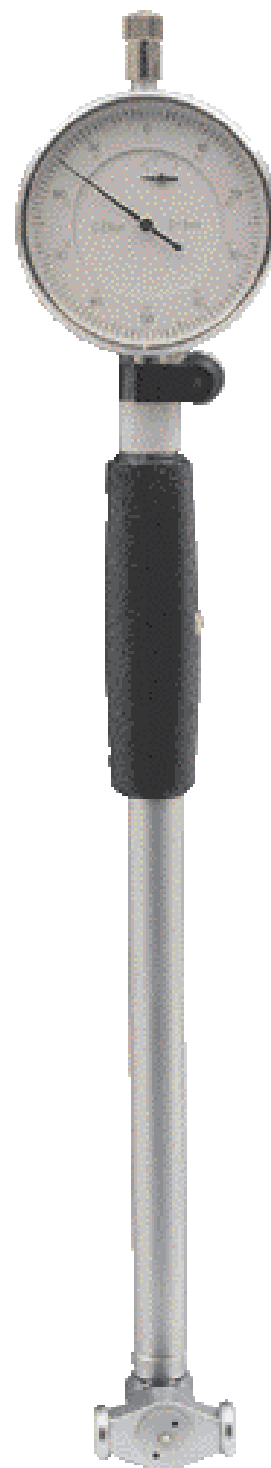

Type	Resolution	Face Dial	Reading	Travel Per Rev	Total Travel
Metric	0.01mm	57mm	0-100	1mm	3mm
Inch	0.0005"	2 3/16"	0-25-0	0.050"	0.25"

Range	Bore Depth	Weight each	Order Code
18 - 35	200	0.58kg	<b>-1400K</b>
35 - 50	240	0.95kg	<b>-1450K</b>
50 - 150	240	1.28kg	<b>-1500K</b>
0.7 - 1.5"	7 1/2"	0.53kg	<b>-1000K</b>
1.4 - 2.4"	9"	0.90kg	<b>-1050K</b>
2.0 - 6.0"	9"	1.20kg	<b>-1100K</b>

## OXFORD PRECISION Fixed Rod Depth Micrometers

Ideal for low-range measurements, this non-digital depth micrometer has a 63 or 100mm hardened tool steel base and satin chrome finish. Includes a 'constant force attachment' for use when fitting the interchangeable rods and supplied in a handy case.

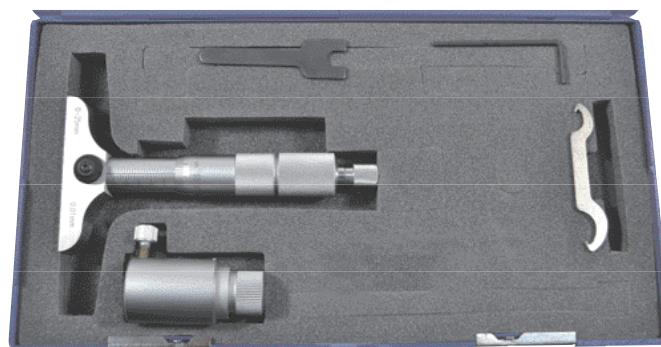

Accuracy	Range	Base Size	Order Code
4 µm (microns)	0 - 25mm	63mm	<b>-3310K</b>
4 µm (microns)	0 - 25mm	100mm	<b>-3330K</b>



## OXFORD PRECISION Enamelled Frame External Micrometers

With enamelled frame and tungsten carbide tipped anvils. High quality fitted metal case with adjusting spanner. Sizes 25 - 50mm/1 - 2" and over supplied with setting standard. Manufactured to **BS 870**. All supplied in a impact resistant fitted plastic case.

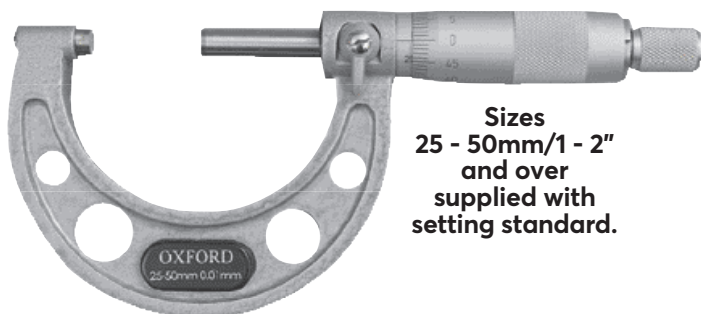

Sizes  
25 - 50mm/1 - 2"  
and over  
supplied with  
setting standard.



Range	Resolution	Weight each	Order Code
<b>Metric</b>			
0 - 25mm	0.01mm	230g	<b>-5010K</b>
25 - 50mm	0.01mm	300g	<b>-5020K</b>
50 - 75mm	0.01mm	400g	<b>-5030K</b>
75 - 100mm	0.01mm	530g	<b>-5040K</b>
100 - 125mm	0.01mm	770g	<b>-5050K</b>
125 - 150mm	0.01mm	800g	<b>-5060K</b>
150 - 175mm	0.01mm	-	<b>-5070K</b>
175 - 200mm	0.01mm	-	<b>-5080K</b>
200 - 225mm	0.01mm	-	<b>-5090K</b>
225 - 250mm	0.01mm	-	<b>-5100K</b>
250 - 275mm	0.01mm	-	<b>-5110K</b>
275 - 300mm	0.01mm	-	<b>-5120K</b>
<b>Inch</b>			
0 - 1"	0.001"	230g	<b>-6010K</b>
1 - 2"	0.001"	300g	<b>-6020K</b>
2 - 3"	0.001"	400g	<b>-6030K</b>
3 - 4"	0.001"	530g	<b>-6040K</b>
4 - 5"	0.001"	770g	<b>-6050K</b>
5 - 6"	0.001"	800g	<b>-6060K</b>

### Micrometer Setting Standards

For setting external micrometers, calipers etc. to zero, providing accurate repeatability of measurements. Flat, lapped measuring ends with fitted heat insulation block. Manufactured to **BS 870**.

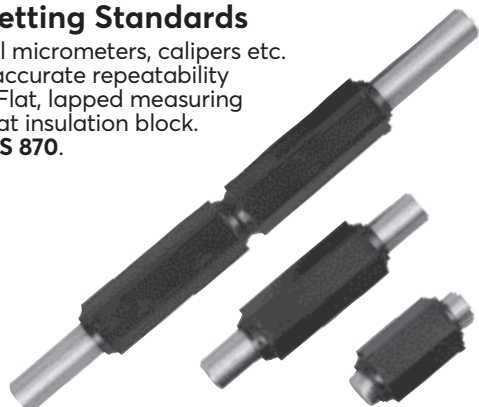

Size	Weight each	Order Code	Size	Weight each	Order Code
25mm	10g	<b>-7010K</b>	1"	10g	<b>-7110K</b>
50mm	10g	<b>-7020K</b>	2"	10g	<b>-7120K</b>
75mm	20g	<b>-7030K</b>	3"	20g	<b>-7130K</b>
100mm	30g	<b>-7040K</b>	4"	30g	<b>-7140K</b>
125mm	40g	<b>-7050K</b>	5"	40g	<b>-7150K</b>
150mm	62g	<b>-7060K</b>	-	-	-
175mm	76g	<b>-7065K</b>	-	-	-
200mm	86g	<b>-7070K</b>	-	-	-
225mm	95g	<b>-7075K</b>	-	-	-
250mm	105g	<b>-7080K</b>	-	-	-
275mm	115g	<b>-7085K</b>	-	-	-
300mm	268g	<b>-7090K</b>	-	-	-

## KENNEDY QUALITY INDUSTRIAL TOOLING Enamelled Frame External Micrometers

Enamelled frame and tungsten carbide tipped anvils. Manufactured to **BS 870**. Supplied in a durable plastic case.

**Accuracy:**

**Flatness:** 0.6mm.

**Parallelism:**  $(2 + L/100) \mu\text{m}$  (fraction rounded down).

**Instrumental error:**  $\pm(1 + L/75) \mu\text{m}$  (fraction rounded up).

L = maximum measuring length.



Range	Resolution	Weight each	Order Code
<b>Metric</b>			
0 - 25mm	0.01mm	230g	<b>-0010K</b>
25 - 50mm	0.01mm	300g	<b>-0020K</b>
50 - 75mm	0.01mm	400g	<b>-0030K</b>
75 - 100mm	0.01mm	530g	<b>-0040K</b>
100 - 125mm	0.01mm	770g	<b>-0050K</b>
125 - 150mm	0.01mm	800g	<b>-0060K</b>

## KENNEDY QUALITY INDUSTRIAL TOOLING Micrometer Stand

**SMS230**

Made of cast iron, it is designed for use with most standard micrometers up to 100mm (4"). The clamp has positive angular and padded parallel clamping jaws. 90° pivoting in the vertical plane.



Product Number	Weight each	Order Code
SMS230	980g	<b>-7230M</b>

## OXFORD PRECISION External Micrometer

Lightweight workshop design with enamel finished frame and carbide tipped anvils. Ratchet stop for consistent measurement and locking clamp. Complete with case.



Range	Resolution	Weight each	Order Code
0 - 25mm	0.01mm		<b>OXD-335</b> <b>-5300K</b>

### Interchangeable Anvil Micrometers

Carbide tipped spindle faces. Hardened and ground anvils. Supplied in metal case with adjusting spanner. Four anvils and three setting standards.

**Accuracy:**  $\pm(4+L/75)$ mm.

**Measuring faces flatness:**  $\pm 0.6$ mm.

**Parallelism:**  $(2+L/100)$ mm.

Range	Resolution	Weight each	Order Code
0 - 100mm	0.01mm	850g	<b>OXD-335</b> <b>-3000K</b>
0 - 150mm	0.01mm	990g	<b>-3020K</b>



### Wire Micrometer

Specially designed for measuring wire diameters 0 - 10mm. The front of the body is flat to help support the wire when measuring. With knurled thimble, ratchet stop and vernier scale barrel, all over satin chrome finish.



Capacity	Resolution	Weight each	Order Code
0 - 10mm	0.002mm	150g	<b>OXD-335</b> <b>-2000K</b>

### Interchangeable Anvil Micrometers

Oxford's versatile range of micrometers with interchangeable anvils with ratchet top, lock, setting standards and wooden case. Rigid and stable cast iron frame that is perforated for lightness.

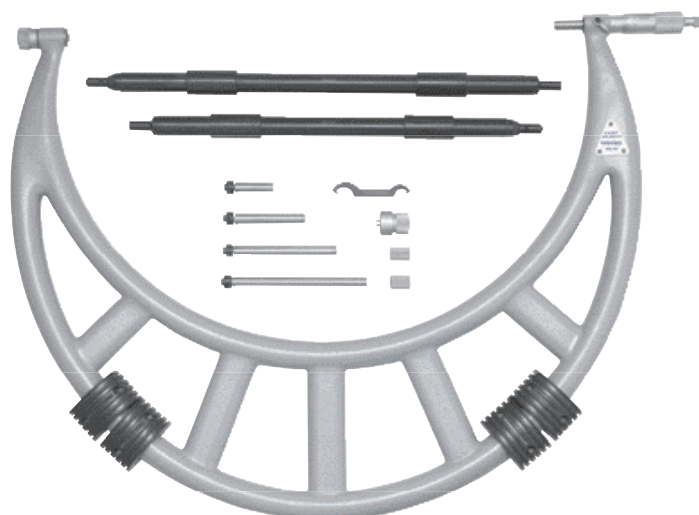

Product Number	Range	Order Code
2425-0400	300 - 400mm	<b>OXD-335</b> <b>-3100K</b>
2425-0500	400 - 500mm	<b>-3120K</b>
2425-0600	500 - 600mm	<b>-3140K</b>

## OXFORD PRECISION Mechanical Digital Micrometer - 0 - 25mm

Direct reading external micrometer for quick and easy reading. With enamelled frame and tungsten carbide precision ground micro finish measuring faces.

**Measuring range:** 0 - 25mm.

**Resolution:** 0.01mm, 0.5mm screw pitch with lock.

Supplied in a robust case with setting key, with fitted heat shield on frame.



Order Code  
**OXD-335**  
-4100K

## 30° Anvil Micrometers

Used for measuring within small grooves or recesses and for quick comparisons of thread accuracy in screw cutting operations. With knurled thimble, ratchet stop and thumb lock. Enamelled frame with satin chromed finish barrel and sleeve.

**Measuring range:** 0 - 25mm.

**Resolution:** 0.01mm.



Order Code  
**OXD-335**  
-3520K

## Micrometer Head

### Spherical Face

Supplied with setting keys.

**Spindle diameter:** 5mm.

**Spindle housing diameter:** 9.5mm.

**Main body diameter:** 14mm.

**Accuracy:** 0.004mm.

**Range:** 0 - 13mm.

**Resolution:** 0.01mm.

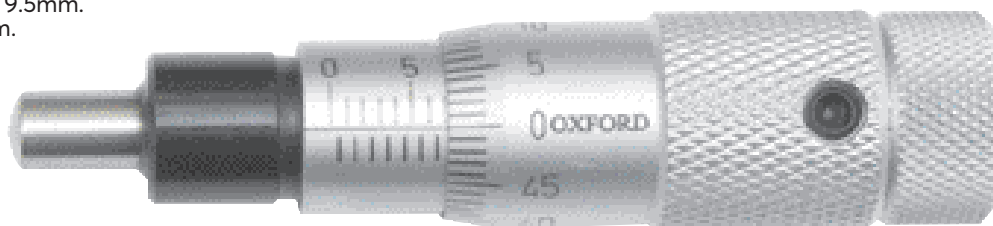

Order Code  
**OXD-335**  
-8200K

**OXFORD PRECISION** Precision Tool Set

Multi-purpose precision set supplied in plastic fitted bench case.

**Contents:**  
 0 - 25mm and 25 - 50mm external micrometer, 25mm setting standard, two micrometer setting spanners, 125mm/5" vernier caliper, 150mm/6" rule with pocket clip, 300mm/12" engineers' rule, 100mm engineers' square, pocket scriber with clip.

**10  
PIECES**

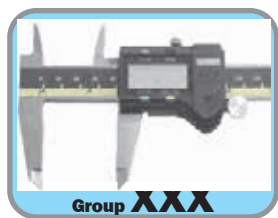
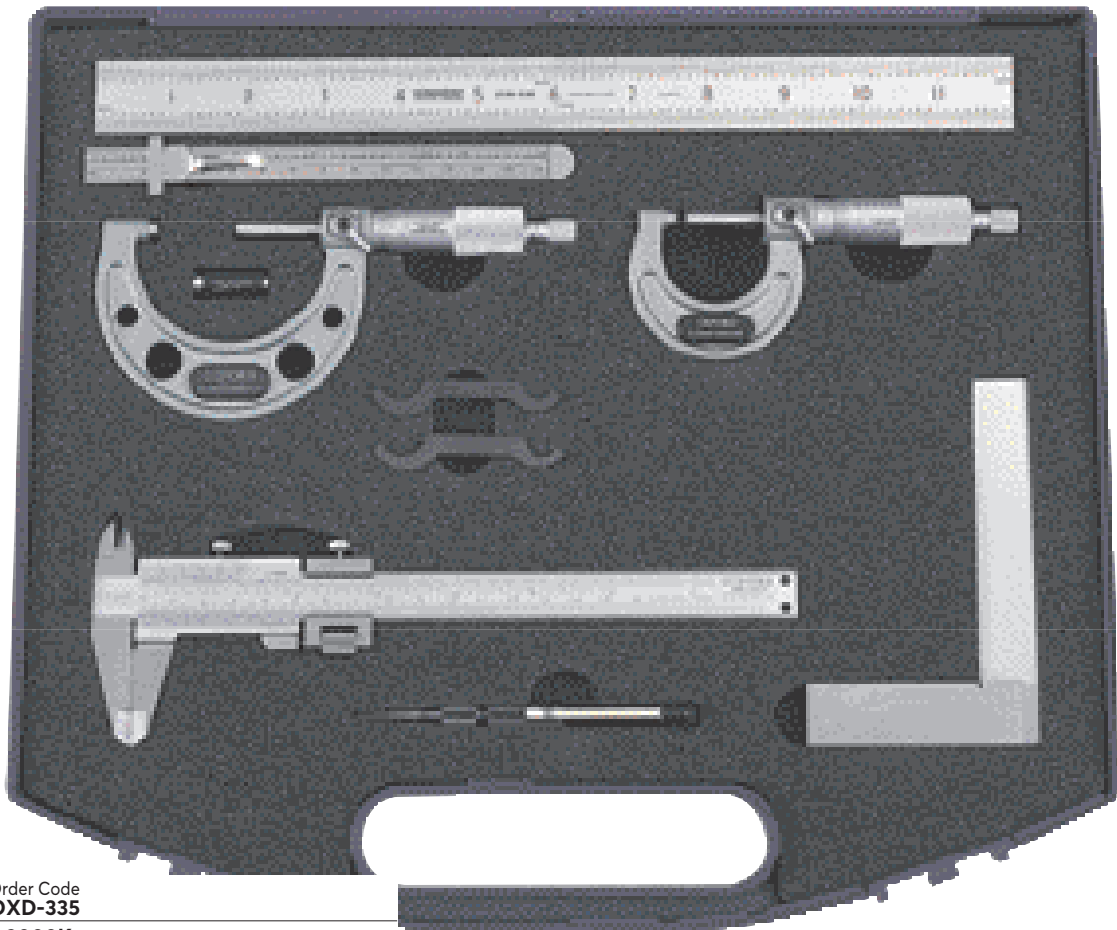

Weight each  
150g

Order Code  
**OXD-335**  
**-9000K**

**External Micrometer Sets**

With enamelled frame and tungsten carbide tipped anvils and fine adjustment ratchet. Supplied in plastic fitted bench case.

**Contents:**  
**-5500K**  
 0 - 25mm, 25 - 50mm, 50 - 75mm and 75 - 100mm external micrometers, 25mm, 50mm and 75mm micrometer setting standards, two micrometer setting spanners.

**-6600K**  
 0 - 1", 1 - 2", 2 - 3" and 3 - 4" external micrometers, 1", 2" and 3" micrometer setting standards, two micrometer setting spanners.

**4  
PIECES**

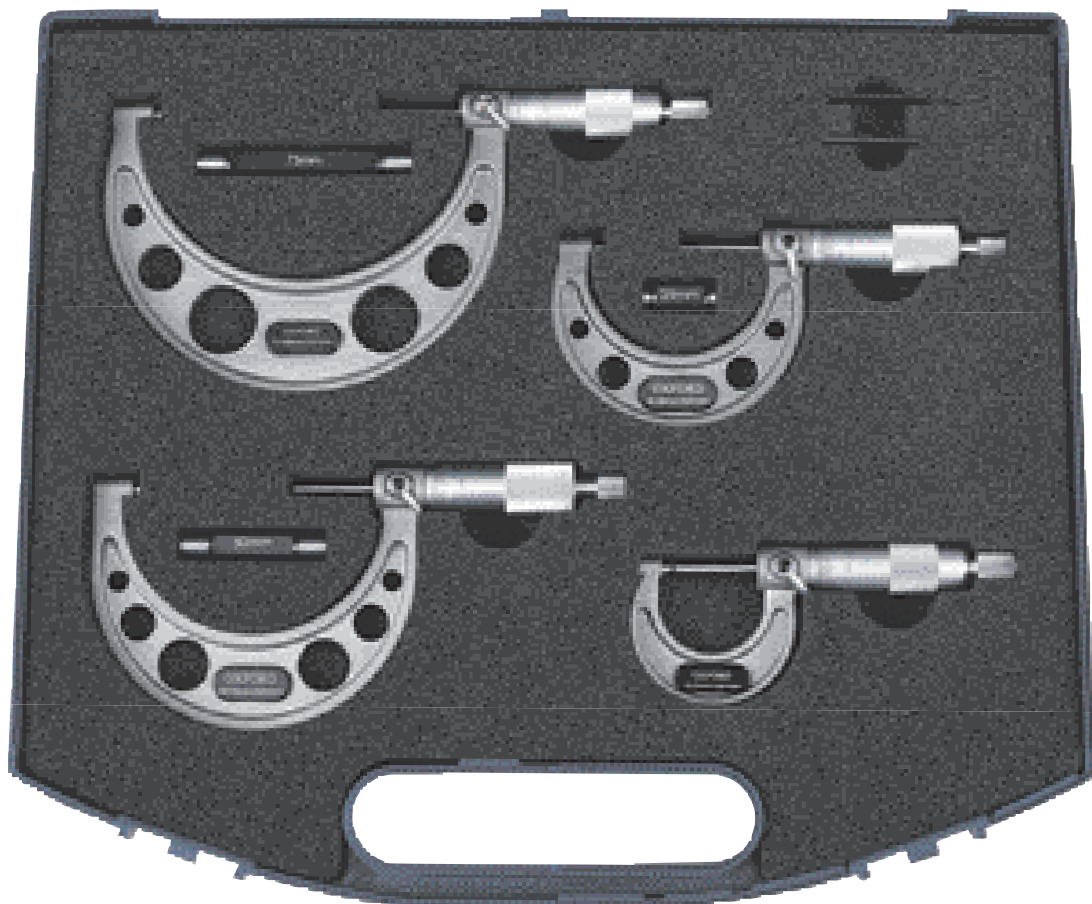

Range	Resolution	Weight each	Order Code
0 - 100mm	0.01mm	1.90kg	<b>OXD-335</b> <b>-5500K</b>
0 - 4"	0.0001"	1.90kg	<b>-6600K</b>

**OXFORD**  
PRECISION

## Apprentice Engineer's Tool Set

### Contents

150mm (6") engineer's rule, 0 - 25 and 25 - 50mm micrometers, 25mm setting standard, 10x magnification eye loupe, 150 (6") digital caliper, 0.5 - 1.0mm 20 blade feeler gauge, 51 metric 60° screw pitch gauge, pocket scribe. Technical data handbook.

**10**  
PIECES



Weight each  
1.75kg

Order Code  
**OXD-335**  
**-9200K**

**OXFORD**  
PRECISION

## Portable Optical Refractometer

For determining the concentration of oil in water emulsions and transparent solutions, such as machine shop coolant. Maintaining the correct mixture in coolant systems is vital to ensure optimum performance from cutting tools. To protect the machine and workpiece from corrosion and to reduce the risk of health hazards arising from incorrect concentrations of water soluble oils. To economise the use of water base cutting fluids and grinding fluids.

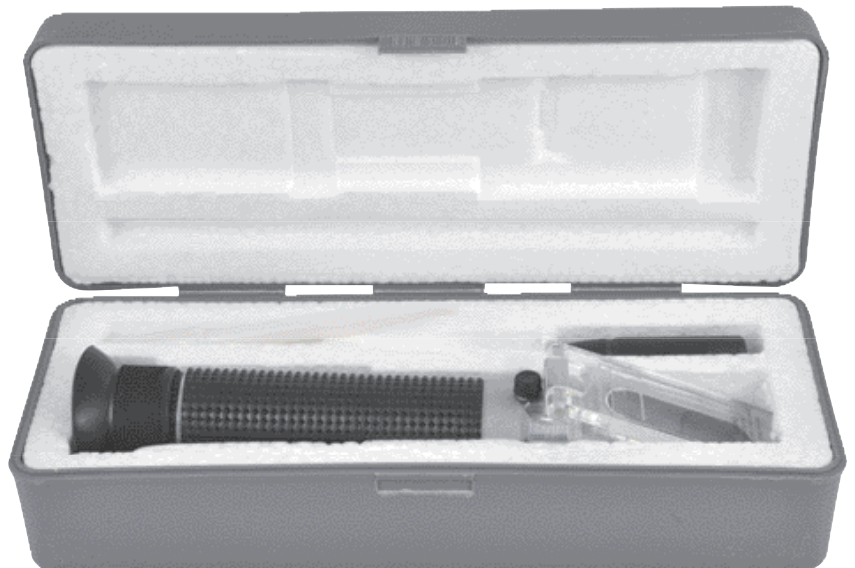

### Specifications:

**Range ND:** 1.333 - 1.356. Bx: 0 - 15%.

**Eyepiece magnification:** 11x.

**Telescopic lens magnification:** 4x.

**Accuracy:** ±0.0003 ±0.2%.

**Lattice value:** 0.0005 0.2%.

Supplied in fitted plastic case complete with calibration screwdriver and operator manual.

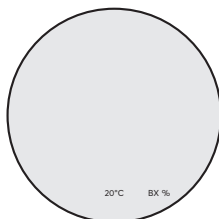

**Calibrated Refractive Scale**



### Refractometer

Description	Weight each	Order Code
Lens for Portable Refractometer	10g	<b>OXD-398</b>

### Spares

Dimensions	Weight each	Order Code
38 x 38 x 185mm	30g	<b>OXD-336</b>

**KENNEDY** QUALITY INDUSTRIAL TOOLING **Steel Gauge Block Sets**

Supplied in high quality wooden bench cases, complete with **UKAS** certificate of calibration. Available in two grades. Manufactured to **BS EN ISO 3650**.

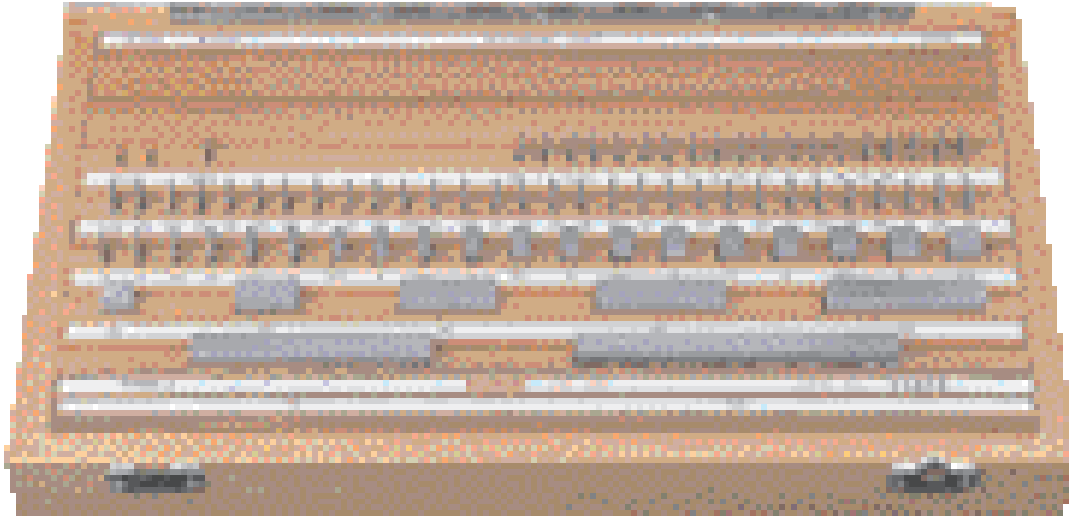

**Grade 2: For Workshop Use**

No. of Pieces	Range (inclusive)	Increments	Weight each	Order Code <b>KEN-338</b>
<b>36-Piece Inch</b>				
(2)	.05"-.10"	.05"	2.4kg	<b>-3360K</b>
(9)	.1001-.1009"	.0001"		
(9)	.101-.109"	.001"		
(9)	.110-.190"	.010"		
(4)	.2-.5"	.10"		
(3)	1, 2 & 4"			
<b>81-Piece Inch</b>				
(9)	.1001-.1009"	.0001"	4.0kg	<b>-3810K</b>
(49)	.101-.149"	.001"		
(19)	.05-.95"	.05"		
(4)	1-4"	1"		

No. of Pieces	Range (inclusive)	Increments	Weight each	Order Code <b>KEN-338</b>
<b>88-Piece Metric</b>				
(1)	1.0005mm		2.8kg	<b>-4880K</b>
(9)	1.001-1.009mm	.001mm		
(49)	1.01-1.49mm	.01mm		
(20)	.5-10mm	.5mm		
(9)	20-100mm	10mm		

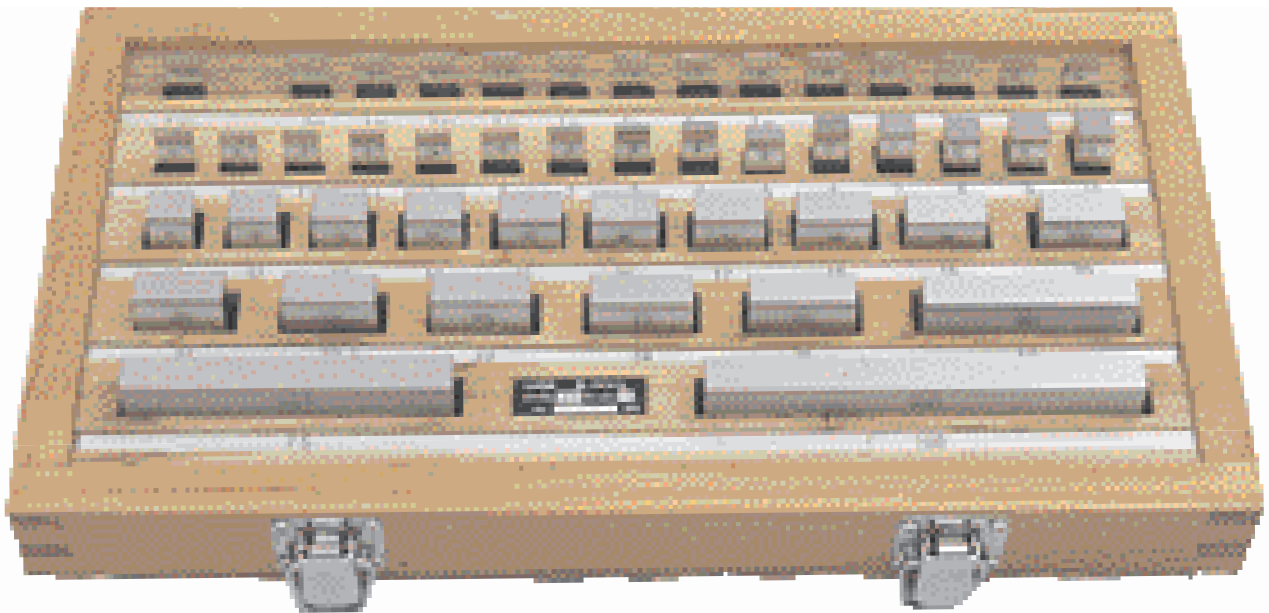

**Grade 1: For Inspection Use**

No. of Pieces	Range (inclusive)	Increments	Weight each	Order Code <b>KEN-339</b>
<b>81-Piece Inch</b>				
(9)	.1001-.1009"	.0001"	4.0kg	<b>-4810K</b>
(49)	.101-.149"	.001"		
(19)	.05-.95"	.05"		
(4)	1-4"	1"		

No. of Pieces	Range (inclusive)	Increments	Weight each	Order Code <b>KEN-339</b>
<b>47-Piece Metric</b>				
(1)	1.005mm		2.4kg	<b>-5470K</b>
(9)	1.01-1.09mm	.01mm		
(9)	1.1-1.9mm	.10mm		
(24)	1-24mm	1mm		
(4)	25-100mm	25mm		
<b>88-Piece Metric</b>				
(1)	1.0005		2.8kg	<b>-5880K</b>
(9)	1.001-1.009mm	.001mm		
(49)	1.01-1.49mm	.01mm		
(20)	.5-10mm	.5mm		
(9)	20-100mm	10mm		



## Adjustable Steel Squares

Made from hardened steel and precision ground. Supplied with three fully adjustable blades. One plain, parallel blade for use as a conventional engineer's square, 30° and 45° bevel edged blade for checking angles, and a narrow blade graduated metric and imperial.

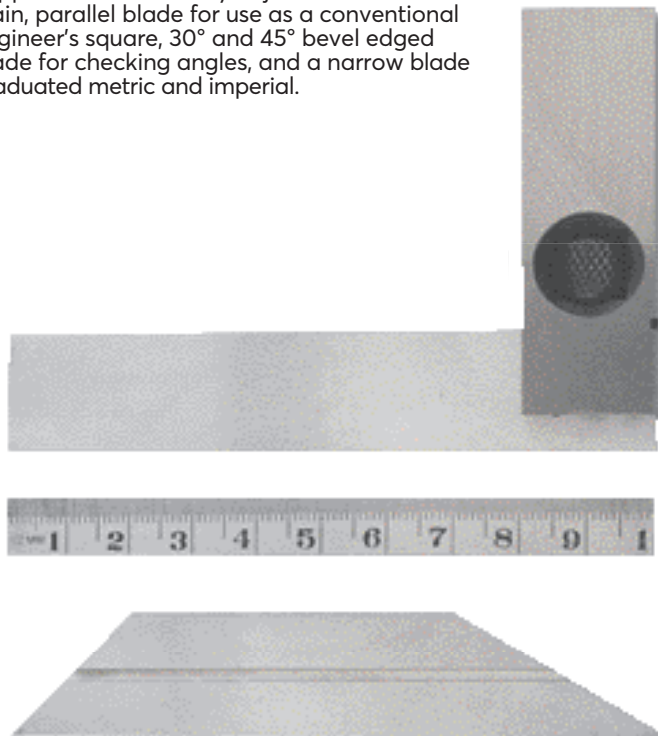

Measured Length	Weight each	Order Code
100mm/4"	340g	<b>-4150K</b>
150mm/6"	410g	<b>-4160K</b>



## Digital Protractor

This digital protractor has a range of 360° split into 4 x 90° quadrants. It is simple to calibrate and the intelligent display changes orientation at 90° and 270° to remain readable. It has a 'V' groove on the top and bottom for easy placement on acute angled or cylindrical objects. 3V lithium battery gives up to 2000 hours use. Complete with a leatherette pouch that has a belt loop.

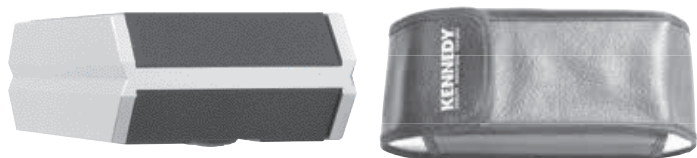

Product Number	Range	Resolution	Weight each	Order Code
PDV360	360° (90° x 4)	0.1°	10.2kg	<b>-4020K</b>



## Engineer's Squares

Manufactured from hardened steel that has been precisely ground to produce parallel edges so that the square has an exact right angle on both the inside and outside of the stock and blade, to ensure accuracy. Conforms to **BS939 Grade B**.



Size (mm)	tol. (mm)	Order Code
75 (3")		<b>-0030K</b>
100 (4")		<b>-0040K</b>
150 (6")	+/- 0.016	<b>-0060K</b>
225 (9")		<b>-0090K</b>
300 (12")	+/- 0.024	<b>-0120K</b>



## Engineer's Levels

Manufactured from hardened steel that has been precisely ground to produce parallel edges so that the square has an exact right angle on both the inside and outside of the stock and blade, to ensure accuracy. Conforms to **BS939 Grade B**.

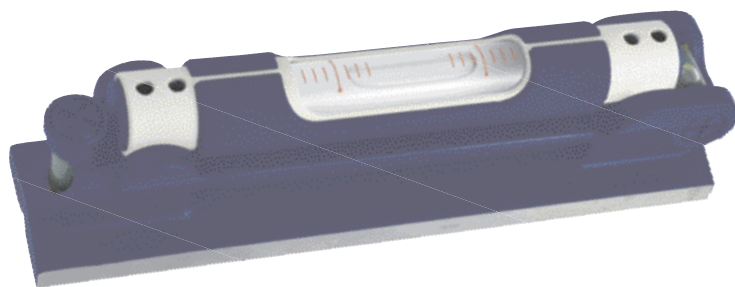

Size (mm)	Order Code
165 x 34	<b>-4940K</b>
310 x 36	<b>-4970K</b>

## OXFORD PRECISION Steel Parallels

Hardened and ground steel parallels for workshop use. Supplied in pairs for packing or levelling components prior to machining in tool rooms or machine shops.

Supplied in Pairs

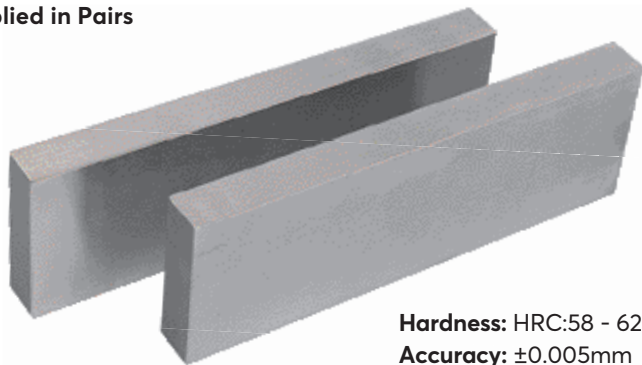

**Hardness:** HRC:58 - 62  
**Accuracy:** ±0.005mm

Dimensions Length x Width x Height	Order Code OXD-372
8 x 15 x 100mm	-4080K
10 x 4 x 160mm	-3700K
10 x 20 x 100mm	-4100K
12 x 20 x 100mm	-4120K
14 x 10 x 150mm	-3800K
14 x 4 x 160mm	-3710K
16 x 10 x 150mm	-3810K
18 x 4 x 160mm	-3720K
18 x 10 x 150mm	-3820K
20 x 10 x 150mm	-3830K
22 x 4 x 160mm	-3730K
22 x 10 x 150mm	-3840K
24 x 10 x 150mm	-3850K
26 x 4 x 160mm	-3740K
26 x 10 x 150mm	-3860K
28 x 10 x 150mm	-3870K
30 x 4 x 160mm	-3750K
30 x 10 x 150mm	-3880K
32 x 10 x 150mm	-3890K
34 x 4 x 160mm	-3760K
35 x 10 x 150mm	-3900K
38 x 4 x 160mm	-3770K
40 x 10 x 150mm	-3910K
42 x 4 x 160mm	-3780K
45 x 10 x 150mm	-3920K
50 x 10 x 150mm	-3930K

### 18 Piece Set

**Contents:** nine pairs of the following sizes:

10 x 4 x 160mm,

- 1.
- 1E
- 2.
- 2E
- 3.
- 3E
- 4.
- St
- st



**18  
PIECES**

Weight each  
2.8kg

Order Code  
OXD-372  
-3620K

### 16 Piece Set

**Contents:** eight pairs of the following sizes:

- 5 x 16 x 100mm,
  - 6 x 18 x 100mm,
  - 8 x 24 x 100mm,
  - 10 x 30 x 100mm,
  - 12 x 36 x 150mm,
  - 14 x 48 x 150mm,
  - 18 x 60 x 150mm,
  - 22 x 62 x 150mm.
- And support blocks.

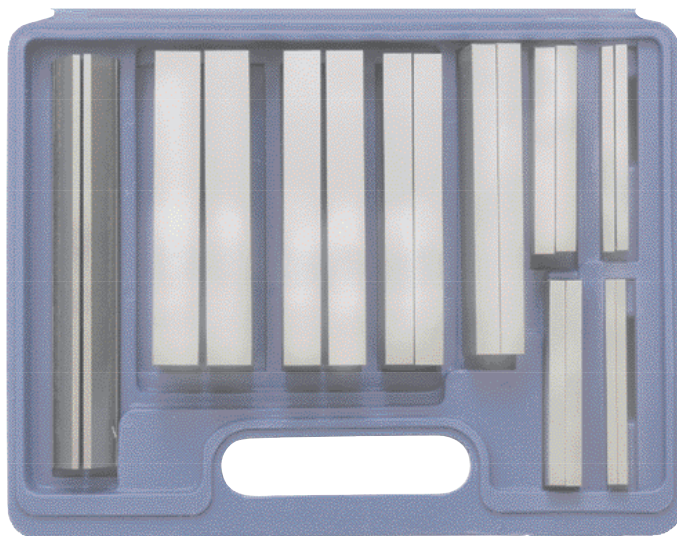

**16  
PIECES**

Weight each  
12.7kg

Order Code  
OXD-372  
-3600K

### 28 Piece Set

**Contents:** fourteen pairs of the following sizes:

- 14 x 10 x 150mm,
- 16 x 10 x 150mm,
- 18 x 10 x 150mm,
- 20 x 10 x 150mm,
- 22 x 10 x 150mm,
- 24 x 10 x 150mm,
- 26 x 10 x 150mm,
- 28 x 10 x 150mm,
- 30 x 10 x 150mm,
- 32 x 10 x 150mm,
- 35 x 10 x 150mm,
- 40 x 10 x 150mm,
- 45 x 10 x 150mm,
- 50 x 10 x 150mm.

Supplied in wooden storage box.



**28  
PIECES**

Weight each  
11.5kg

Order Code  
OXD-372  
-3640K



## OXFORD PRECISION Vee Blocks

Matched and numbered pairs of close grained iron castings accurately machined. Precision 90° vee blocks. Supplied as a pair.

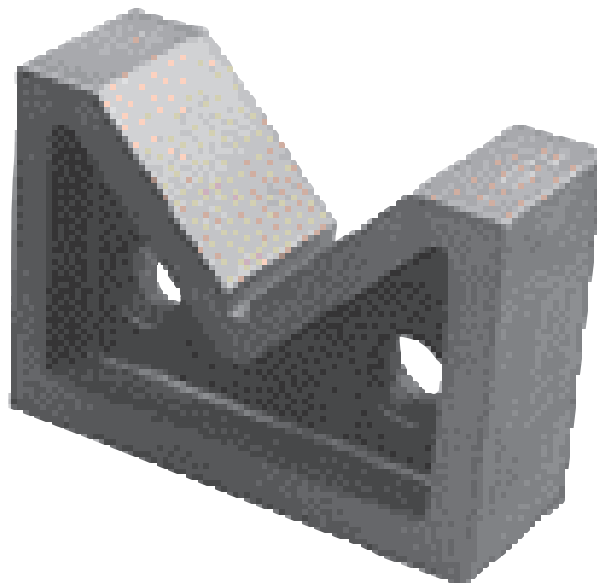
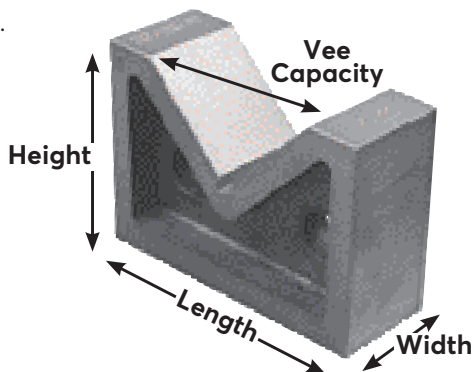

Dimensions L x W x H	Vee Capacity	Weight/ Pair	Order Code <b>OXD-370</b>
75 x 33 x 60mm	45	1.7kg	<b>-2110K</b>
100 x 40 x 65mm	56	2.9kg	<b>-2120K</b>
125 x 50 x 78mm	62	4.8kg	<b>-2130K</b>
150 x 62 x 88mm	78	6.5kg	<b>-2140K</b>
200 x 100 x 140mm	113	11.2kg	<b>-2150K</b>
250 x 125 x 165mm	125	19.0kg	<b>-2160K</b>

### Workshop Vee Blocks & Clamp

Designed for checking precision machine parts. Hardened and precision ground steel supplied in matched pairs, each with V-grooves central and parallel to the sides and base ensuring perfect alignment. Complete set with two V-blocks (one pair) and two clamps.



Dimensions Length x Width x Height	Weight/ Pair	Order Code <b>OXD-370</b>
50 x 37 x 37mm	1.0kg	<b>-2300K</b>

### Workshop Grade Hollow Ground Vee Blocks & Clamp

Designed for checking precision machine parts. Hardened and precision ground steel supplied in matched pairs, each with V-grooves central and parallel to the sides and base ensuring perfect alignment. Complete set with two V-blocks (one pair) and two clamps. Supplied with malleable iron clamps with steel screws.

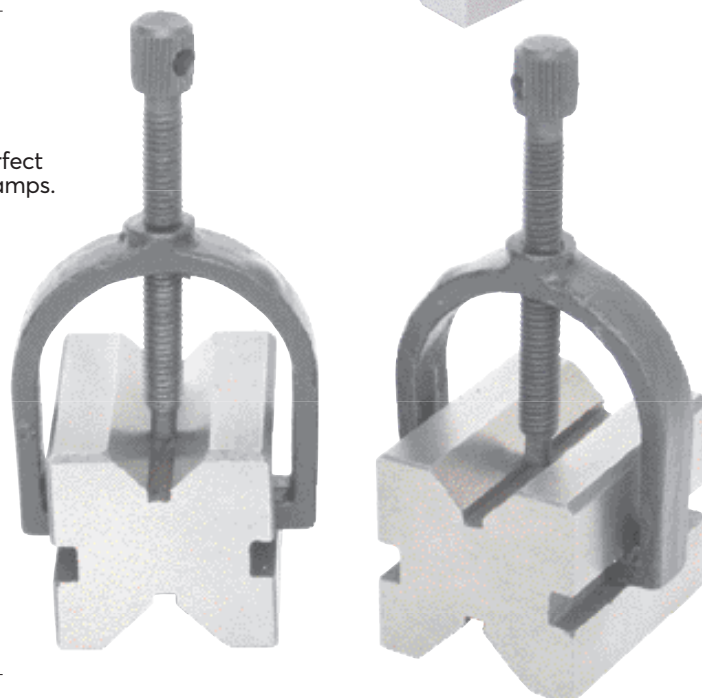

Dimensions Length x Width x Height	Weight/ Pair	Order Code <b>OXD-370</b>
31.5 x 40 x 31.5mm	1.7kg	<b>-2310K</b>

## OXFORD PRECISION Angle Plates

### Open End

Open end angle plates are versatile accessories which can be used to clamp and hold work in a vertical position for planing, milling, or drilling. Work can be clamped and rotated through several planes for measurement or machining without repositioning. The slots allow work to be easily fastened to the plate, and the plate to a fixture base or machine bed. Manufactured from close grained cast iron. **BS : 5535 Grade B.**



### Webbed End

Webbed slotted angle plates can be used for rapid mounting fixtures for machine set-up, layout, or inspection. They are heavily ribbed for strength and rigidity. Sides and ends are machine finished. Manufactured from close grained cast iron. **BS : 5535 Grade B.**



Dimensions Length x Width x Height	Weight each	Order Code
12½" x 10" x 8"	27.0kg	<b>OXD-370</b>

Dimensions Length x Width x Height	Weight each	Order Code
12½" x 10" x 8"	26.5kg	<b>OXD-370</b>

## Electronic Weighing Scales

Digital display. Designed to run on mains power via the 12Vdc 650mA AC adaptor provided or the 6V4AH rechargeable battery (included). Units will run up to 20 hours on a single full charge.

**Capacity:** 15kg/31lb.

**Resolution:** 0.002kg/0.005lb.

## KENNEDY Liquid Measures

Chemical and oil resistant polyethylene liquid measures.



Capacity (Litres)	Resolutions	Weight	Order Code
¼	¼ ltr - 10ml	45g	<b>-5500K</b>
½	½ ltr - 10ml	75g	<b>-5520K</b>
1	1 ltr - 10ml	100g	<b>-5540K</b>
2	2 ltr - 20ml	180g	<b>-5560K</b>
3	3 ltr - 50ml	260g	<b>-5580K</b>
5	5 ltr - 100ml	360g	<b>-5600K</b>



Model No.	Maximum Capacity	Order Code
WS-15E	15kg	<b>-2220K</b>